

**Noise Symptom - Squeaking Noises at Low Speed From the Rear Axle Area: Observe Specified Procedure (SY 111/20)**

Model Line: **Cayenne (9YA/9YB)**

Model Year: **As of 2018 up to 2020**

Equipment: **PSCB disc brakes, rear (I-no. 2EQ/2ES)**

Subject: **Porsche Surface Coated Brake (PSCB)**

Symptom: Squeaking noises can be heard from the rear axle area at low speed or slight brake actuation.

Cause: Touching the brake pad and brake calliper at certain points can cause the squeaking noise.



**Information**

Please refer to workshop campaign WKF8 if it affects the vehicle ⇒ *Technical Information 'WKF800 WKF8 Workshop campaign - Replacing PSCB brake pads on front axle and replacing brake pad retainer springs on rear axle'*.

Remedial Action: In the event of a customer complaint and if workshop campaign WKF8 has already been carried out, attach adhesive pads to the back of the brake pads.

**Parts required**

Parts Info:	<b>Part No.</b>	<b>Designation</b>	<b>Qty.</b>
		<b>– Use</b>	
	9Y0698030	⇒ Repair kit for rear PSCB brake pads – contains adhesive pads	1 ea.
	N 91183701	⇒ Cheese head bolt with multiple-tooth head – rear brake calliper	4 ea.

**Preparatory work**

- 1 Remove rear PSCB brake pads, see ⇒ *Workshop Manual '463856 Replacing rear disc brake pads'*.

**Reworking rear PSCB brake pads**

- Work Procedure: 1 Clean the brake pistons and back of the pad backing plates with a damp cloth.
- 2 Dry the back of the pad backing plates with a lint-free cloth.

- 3 Carefully pull upper backing sheet ⇒ *Upper backing sheet -1-* off adhesive pad ⇒ *Upper backing sheet -2-*. Do not touch the bonding surface.

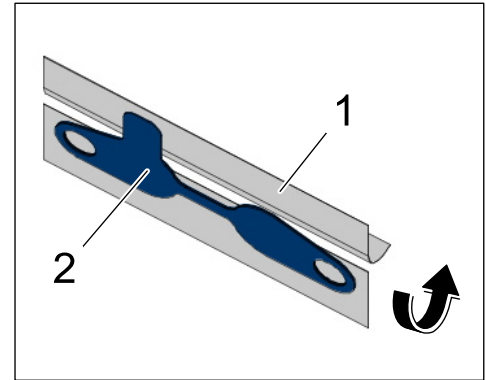

*Upper backing sheet*

- 4 Position adhesive pad ⇒ *Adhesive pad -1-* on the back of the pad backing plate ⇒ *Adhesive pad -2-* as shown and affix. Make sure there are no air bubbles.

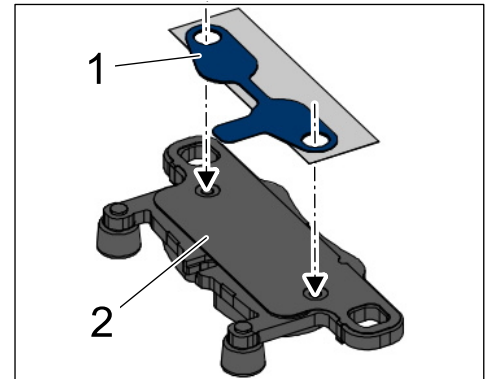

*Adhesive pad*

- 5 Carefully pull off lower backing sheet ⇒ *Lower backing sheet -1-* as shown in upper cut-out ⇒ *Lower backing sheet -in direction of arrow-* and affix adhesive pad ⇒ *Lower backing sheet -2-* over the entire surface as shown in lower cut-out ⇒ *Lower backing sheet -in direction of arrow-*.

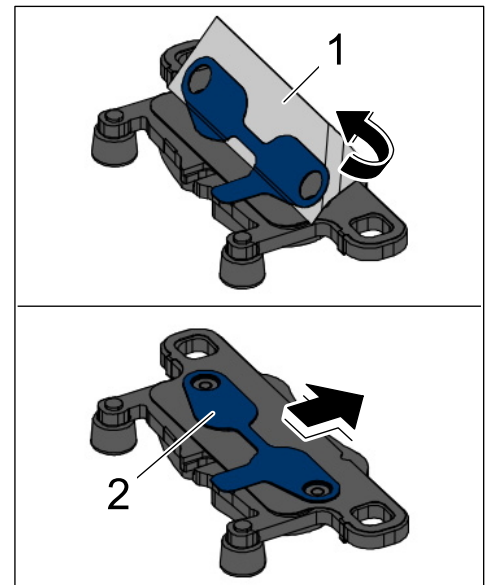

*Lower backing sheet*

- 6 Carefully pull protective film ⇒ *Protective film -1-* off the adhesive pad.

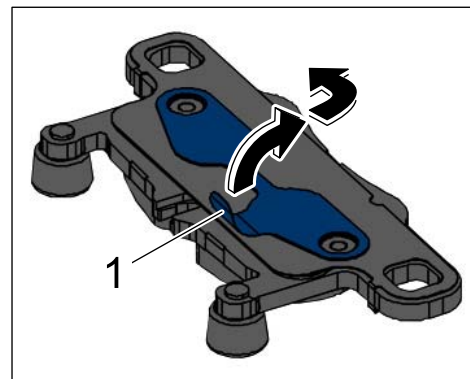

*Protective film*

### Concluding work

- Work Procedure: 1 Install rear PSCB brake pads, see ⇒ *Workshop Manual '463856 Replacing rear disc brake pads'*.
- 2 Actuate the brake pedal five times with medium pressure when the engine is running.

### Invoicing

Invoicing: For documentation and warranty invoicing, enter the labor operations, PQIS coding and part numbers specified below in the warranty claim:

APOS	Labor operation	I No.
46335000	Reworking rear PSCB brake pads	

PQIS coding:

Location (FES5)	46330	Rear PSCB brake pad
Damage type (SA4)	2019	squealing

Parts Info:	Part No.	Designation – Use	Qty.
	9Y0698030	Repair kit for rear PSCB brake pads – contains adhesive pads	1 ea.
	N 91183701	Cheese head bolt with multiple-tooth head – rear brake calliper	4 ea.

References: ⇒ *Technical Information 'WKF800 WKF8 Workshop campaign - Replacing PSCB brake pads on front axle and replacing brake pad retainer springs on rear axle'*  
⇒ *Workshop Manual '463856 Replacing rear disc brake pads'*

**Important Notice:** Technical Bulletins issued by Porsche Cars North America, Inc. are intended only for use by professional automotive technicians who have attended Porsche service training courses. They are written to inform those technicians of conditions that may occur on some Porsche vehicles, or to provide information that could assist in the proper servicing of a vehicle. Porsche special tools may be necessary in order to perform certain operations identified in these bulletins. Use of tools and procedures other than those Porsche recommends in these bulletins may be detrimental to the safe operation of your vehicle, and may endanger the people working on it. Properly trained Porsche technicians have the equipment, tools, safety instructions, and know-how to do the job properly and safely. Part numbers listed in these bulletins are for reference only. The work procedures updated electronically in the Porsche PIWIS diagnostic and testing device take precedence and, in the event of a discrepancy, the work procedures in the PIWIS Tester are the ones that must be followed.

© 2020 Porsche Cars North America, Inc.