

Secure hose connection to the turbocharger. To do this, connect pressure pipe **-2-** and tighten the hose clamp. Then fit the line from the charge air cooler. The connection piece must engage audibly. Ensure that sheetmetal clip **-1-** is fitted correctly.

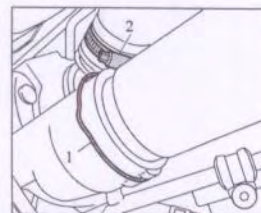

Securing hose connection to the turbocharger

Perform additional assembly work when replacing the three-phase generator

Additional assembly work when replacing three-phase generator



Information

The parts pack of a new three-phase generator contains all the parts required (insulator, PIN and socket).

1. Lay the lead of the new three-phase generator as for the old lead and clip into the three retaining clips **-Arrows A-**.

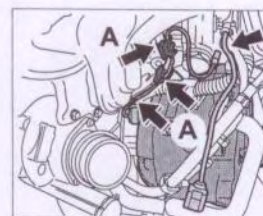

Laying and trimming lead of three-phase generator

2. Trim the lead (with 2-pole plug) included in the engine wiring harness to the three-phase generator **-arrow-** such that, together with the new lead already laid from the three-phase generator, it can be joined without tension and without too much slack.
3. In the wiring harness, insulate and immobilise the wire to PIN 2 of the plug that was cut off.
4. In the wiring harness, remove the insulation of the wire to PIN 1 of the plug that was cut off and push new insulator **-1-** onto the wire.

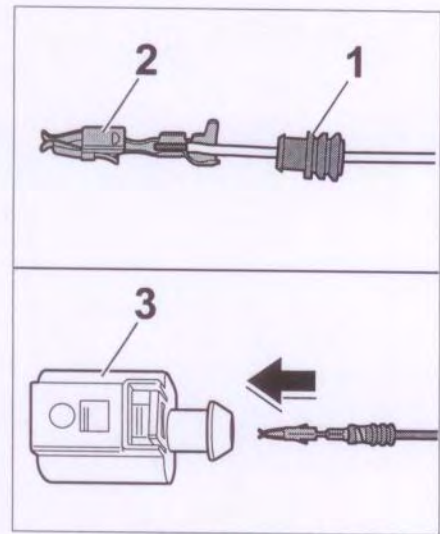

Crimping plug to wiring harness

5. Crimp new PIN -2- using **repair kit for wiring harnesses NR.155-1** and **repair kit for Cayenne wiring harnesses NR.155-2** .
6. Insert wire with new PIN into the new socket -3- and lock.
7. Push the plug connection -1- together until it is felt to engage.

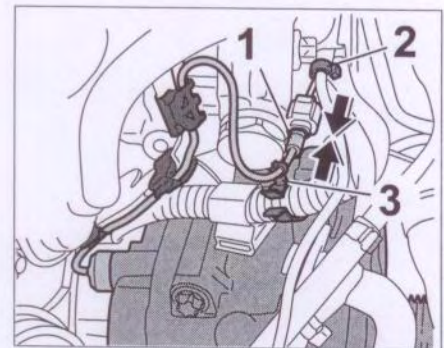

Pushing plug connection together and clipping the line holder

8. Tie the plug connection with a tie-wrap -2- to the nearby wiring harness.
9. Clip line holder -3- to the shaft tube.

Subsequent work

Subsequent work

1. Install drive belt. → *137819 Removing and installing drive belt - chapter on "installing"*

2. Fill in coolant. → *193817 Draining and refilling coolant (includes bleeding) - chapter on "refilling"*
 3. Fasten lock mount. → *503809 Detaching and fastening lock mount (service position) - chapter on "fastening"*
 4. Install right air-cleaner housing → *242519 Removing and installing air cleaner housing - chapter on "installing"*
 5. Install the right wheel housing liner → *505619 Removing and installing front wheel housing liner - chapter on "installing"*
 6. Connect the battery and carry out the work instructions → *90 Work instructions after disconnecting the battery*
 7. Fit engine guard. → *108019 Removing and installing engine guard - chapter on "installing"*
-

9PAAF1

Model year as of 2003

C00, C02, C05, C07, C08, C09, C10, C11, C12, C13, C14, C15, C16, C18, C19, C20, C21, C22, C23, C24, C25, C26, C27, C28, C32, C33, C34, C35, C36, C37, C38, C39, C45, C46, C98, C99