

5	Reserve bores on cone ring ⇒ Figure 1 -5-	Fill bores with grease so that they are 1/3 to 2/3 filled with grease.
6	Inner circular area on cone ring ⇒ Figure 1 -6-	Apply a light coating of grease (approx. 0.2 – 0.5 mm thick).
7	Conical area on cone ring ⇒ Figure 1 -7-	Apply a light coating of grease (approx. 0.2 – 0.5 mm thick).

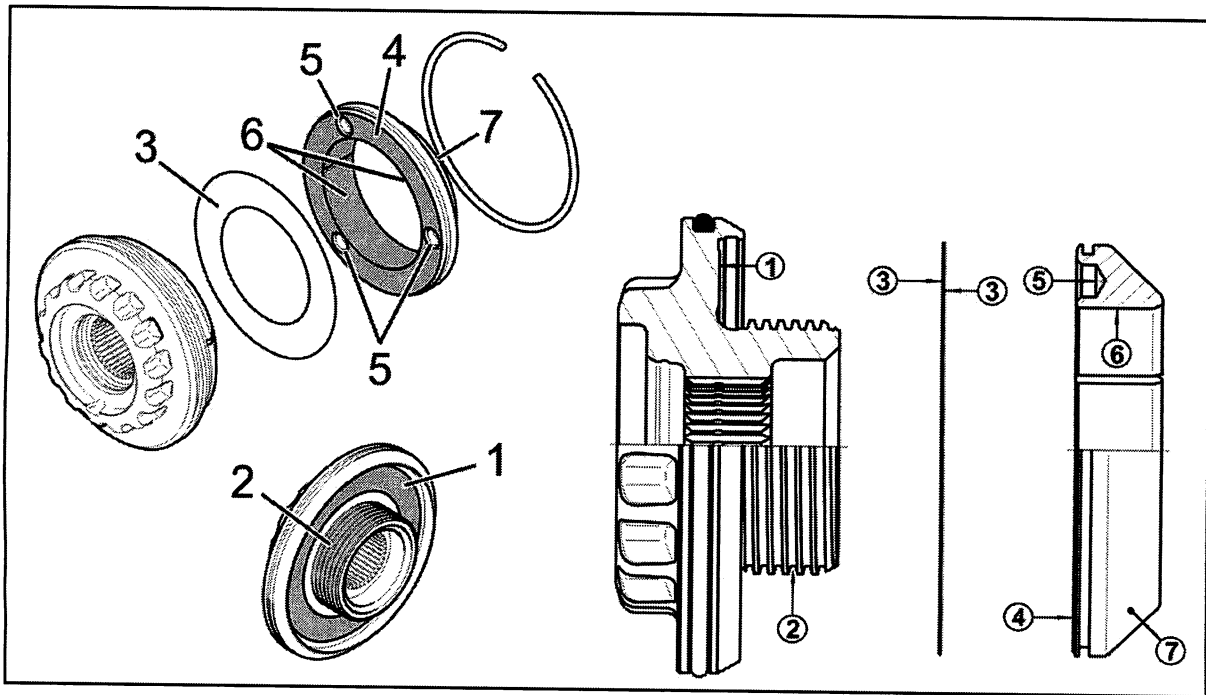

Figure 1

- 2 **Tighten central bolts to a higher tightening torque according to the following sequence before driving the vehicle on race circuits.**