

Pericolo di perdita dell'abbinamento testo-immagine nella stampa.

- **Per motivi tecnici non è escluso che, nonostante la rappresentazione sullo schermo risulti perfetta, durante la stampa venga persa la corrispondenza fra testo e relativa immagine.**
- **Se tale difetto non viene rilevato vi è il pericolo che i lavori non siano eseguiti correttamente; ciò può avere come conseguenza lesioni e danneggiamenti.**

Per questo motivo, dopo la stampa è assolutamente necessario confrontare le stampe con la rappresentazione sullo schermo. In caso di errore si prega di correggere le stampe, così da garantire la riproduzione esatta della rappresentazione sullo schermo.



ADVERTENCIA

Al imprimir se corre el riesgo de perder la correcta asignación de las figuras al texto.

- **Por motivos técnicos, por el momento no se puede descartar que, aun siendo correcta la imagen que aparezca en la pantalla, al imprimir se pierda la correlación entre el texto y la figura correspondiente.**
- **Si este error pasara desapercibido, existe el riesgo de que los trabajos no se ejecuten de forma correcta y, por tanto, se produzcan daños personales y materiales.**

Por ello le rogamos que tras el proceso de impresión compare siempre las copias impresas con la imagen de la pantalla. En caso de error, corrija las copias impresas de forma que se correspondan con el contenido de la imagen de la pantalla.

57 30 19 Removing and installing door unit carrier - as of MY 2005

- [Preliminary work](#)
- [Removing door unit carrier](#)
- [Installing door unit carrier](#)
- [Subsequent work](#)

[top of page](#)

Preliminary work

Preliminary work

1. Disconnect electric lead for door. [973219 Removing and installing wiring harness for door](#)
2. Remove door trim panel. [705919 Removing and installing door trim panel - chapter on "removing"](#)
3. Remove power window motor. [645419 Removing and installing power window motor - chapter on "removing"](#)
4. Remove head airbag. [696619 Removing and installing head airbag - chapter on "removing"](#)

[top of page](#)

Removing door unit carrier

Covering door with adhesive tape

Installation Location:

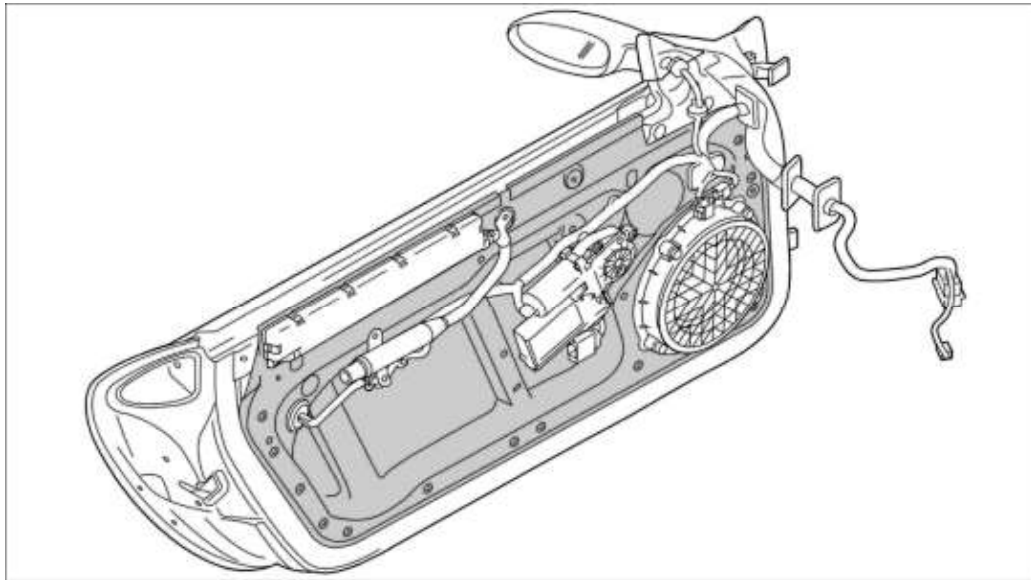

Overview, door unit carrier



Note

- Adhesive tape protects the door from paint damage when removing the door unit carrier.

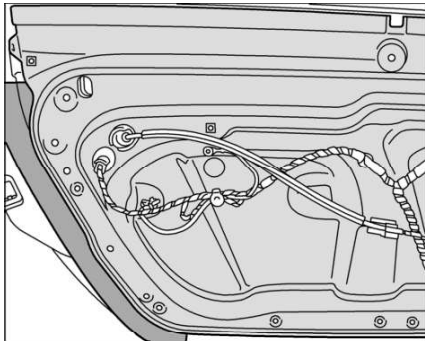

Covering door with adhesive tape

1. Cover door in marked area with adhesive tape.

Removing seal for mirror triangle

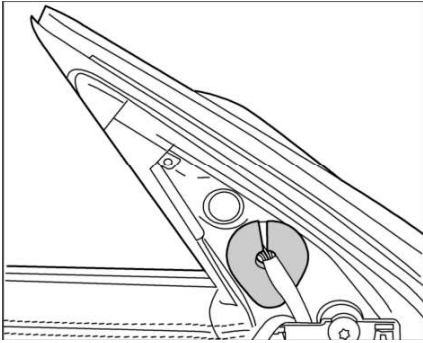

Seal for mirror triangle

1. Pull out seal for mirror triangle from cable cutout opening for door mirror.

Disconnecting electrical plug connection

Installation Location:

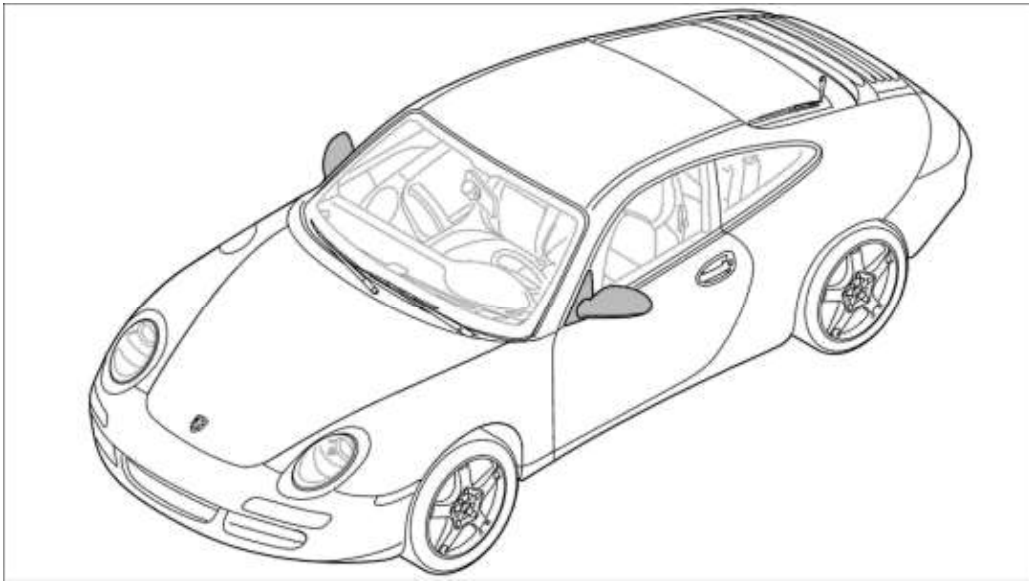

Overview, removing and installing rear-view mirror

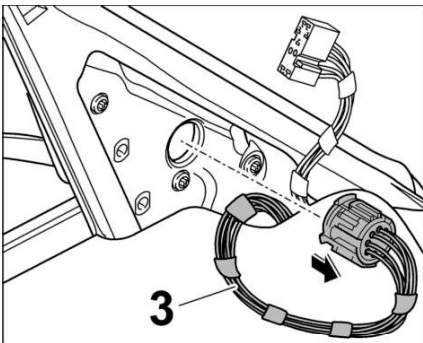

Pulling off electrical plug

1. Disconnect the plug connection of the mirror housing **3**.

Releasing door unit carrier

Installation Location:

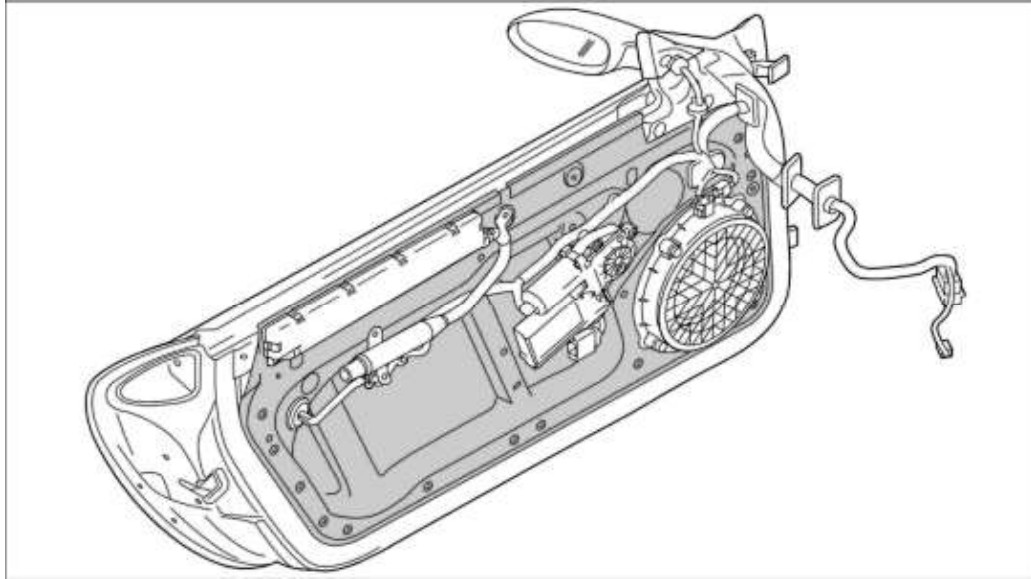

Overview, door unit carrier



Note

- A second person is required for removing the door unit carrier to avoid damage.

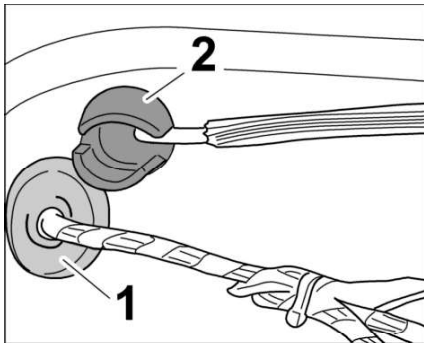

Pressing in rubber grommets

1. Press rubber grommet for electrical wire -1- and bowden cable -2- inwards.

Diagnostic system: reading out fault memory and activating systems

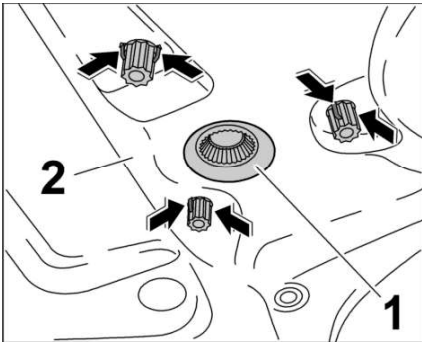

Unclipping power windows

2. Press in the locking tabs **-arrows-** and unclip power windows **-1-** from door unit carrier **-2-** .

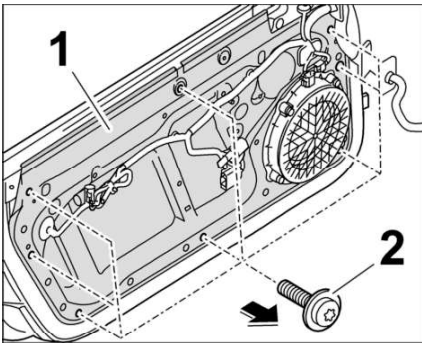

Releasing door unit carrier

3. Unscrew fastening screws **-2-** for the door unit carrier **-1-** .

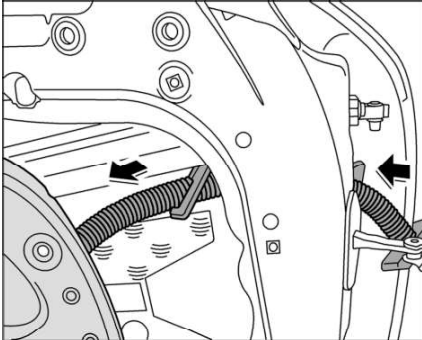

Pulling out the wiring harness

4. Press the rubber grommet on the wiring harness inwards and pull the wiring harness through the door aperture.

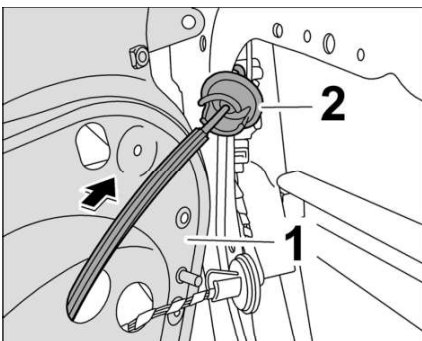

Pulling out the Bowden cable

Diagnostic system: reading out fault memory and activating systems

5. Pull out the bowden cable **-2-** from the unit carrier **-1-** .

Disconnecting electrical plug connection on microswitch

Installation Location:

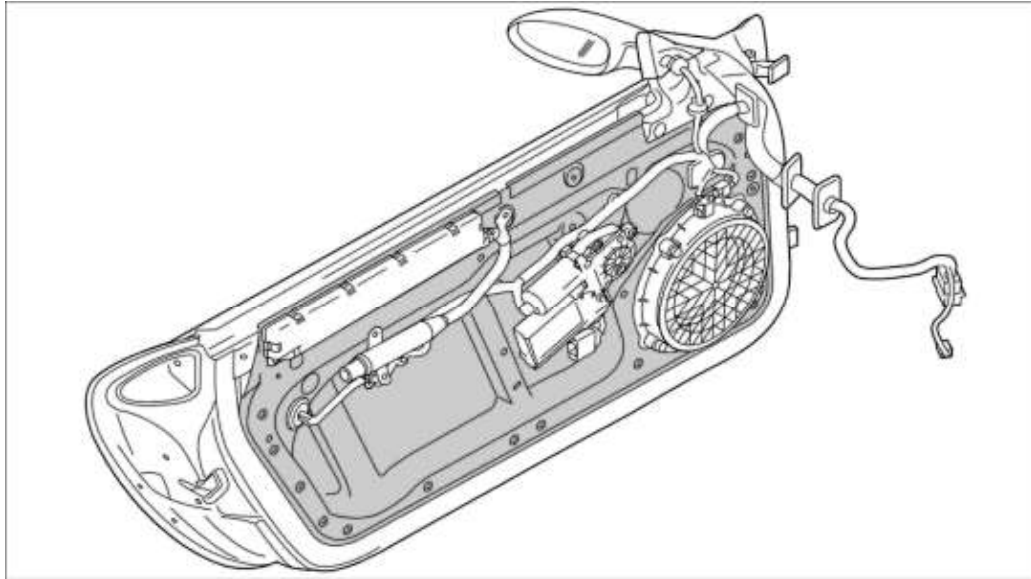

Overview, door unit carrier



Note

- A second person is required for removing the door unit carrier to avoid damage.

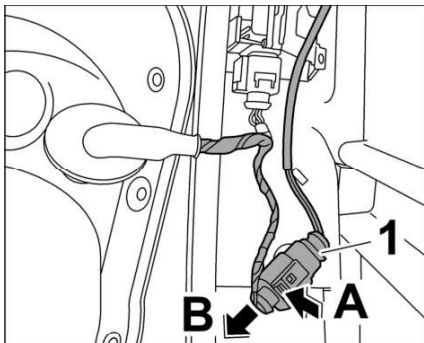

Disconnecting the microswitch plug connection

1. Unlock the electrical plug connection for the microswitch **-1-** by pressing the locking tab **-Pfeil A-** and remove **-Pfeil B-** .

Disconnecting the door lock electrical plug connection

Installation Location:

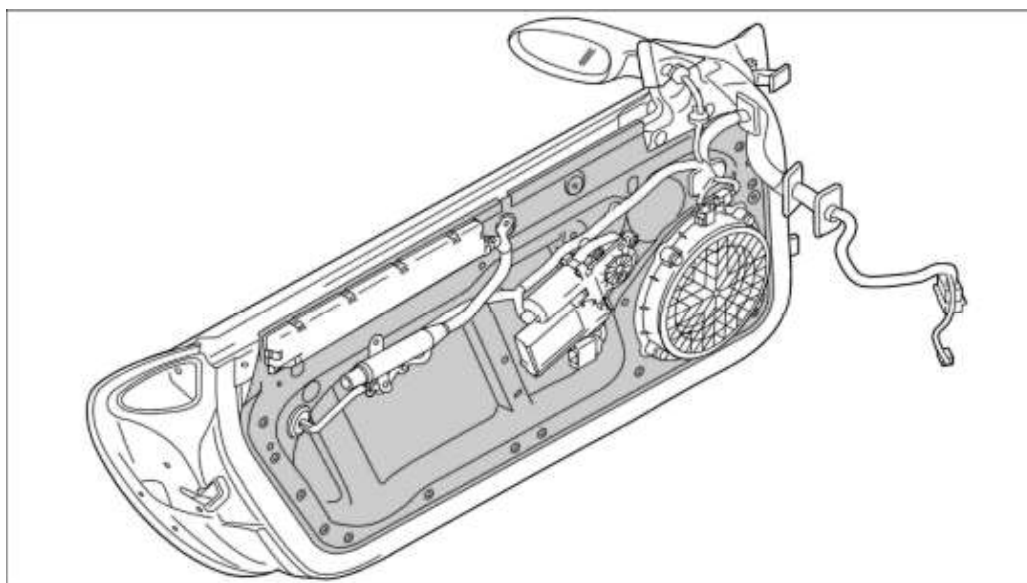

Overview, door unit carrier



Note

- A second person is required for removing the door unit carrier to avoid damage.

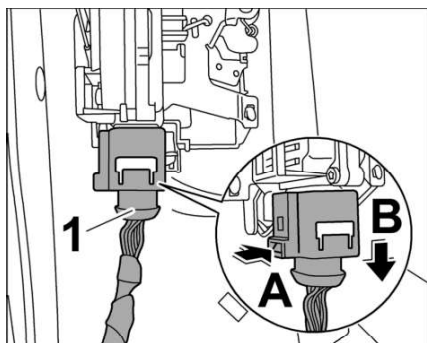

Disconnecting the door lock plug connection

1. Unlock the electrical plug connection for the door lock **-1-** by pressing the locking tab **-Pfeil A-** and remove **-Pfeil B-**.
2. Remove door unit carrier.

[top of page](#)

Installing door unit carrier

Locking electrical plug connection for door lock

Installation Location:

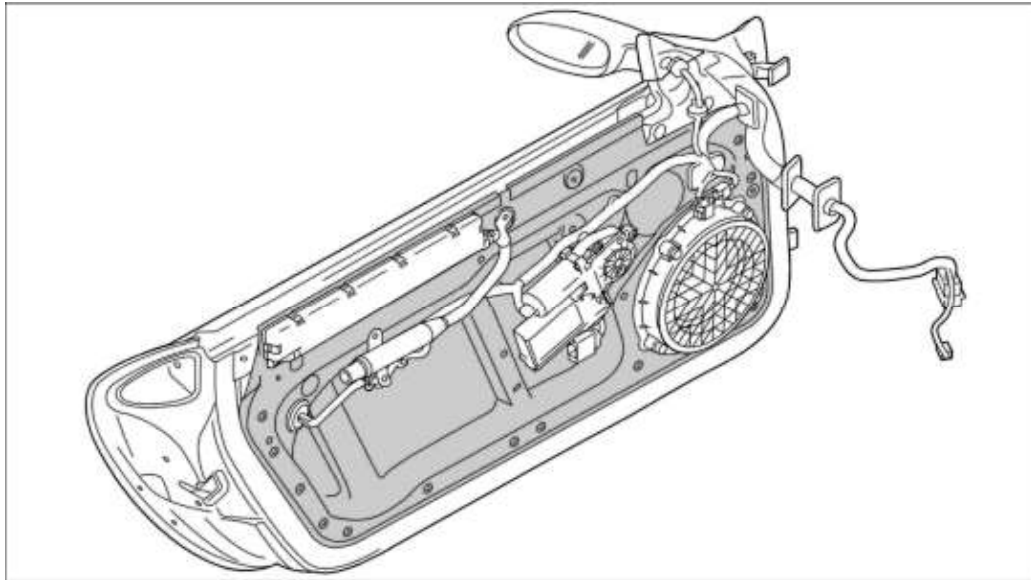

Overview, door unit carrier



Note

- A second person is required for removing the door unit carrier to avoid damage.

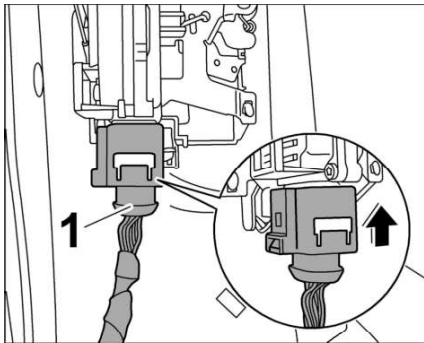

Locking plug connection for door lock

1. Lock electrical plug connection for door lock **-1-** until the plug audibly engages.

Locking electrical plug connection for microswitch

Installation Location:

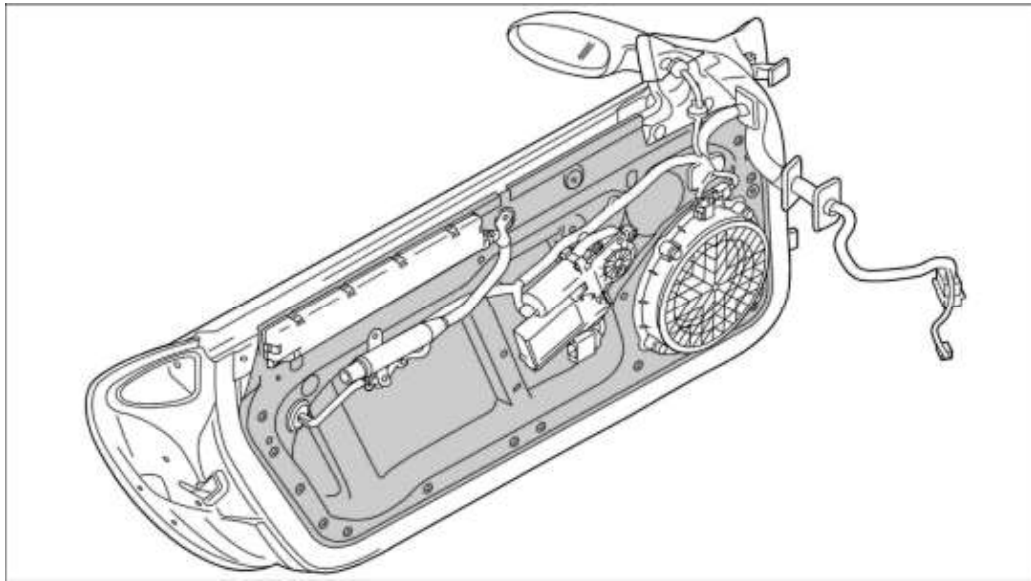

Overview, door unit carrier



Note

- A second person is required for removing the door unit carrier to avoid damage.

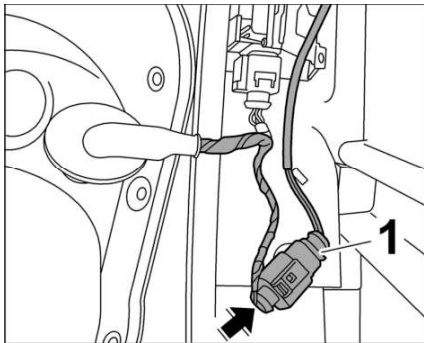

Locking plug connection for microswitch

1. Lock electrical plug connection for microswitch **1** until the plug audibly engages.

Fastening door unit carrier

Installation Location:

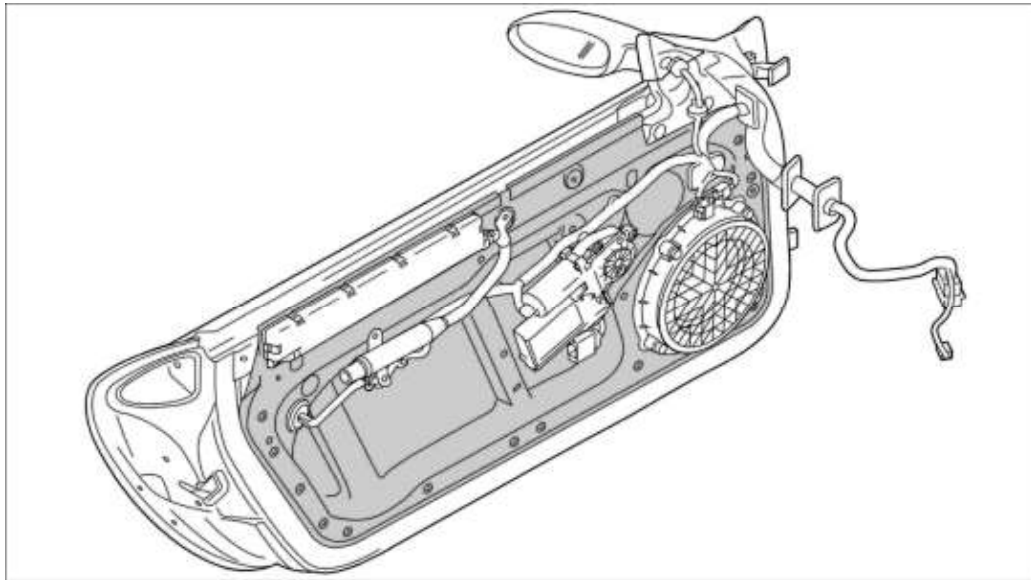

Overview, door unit carrier



Note

- A second person is required for removing the door unit carrier to avoid damage.

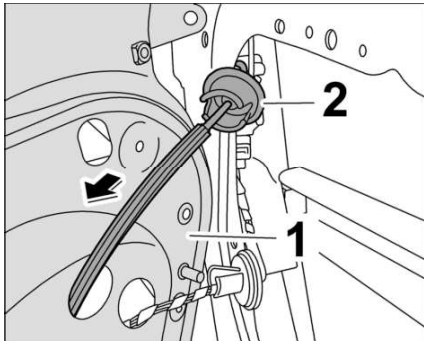

Pushing bowden cable through

1. Push the bowden cable **-2-** through the unit carrier **-1-**.

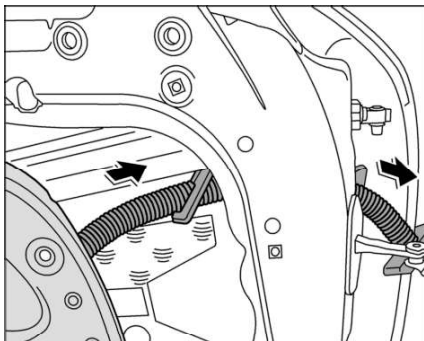

Pushing wiring harness through



Note

Diagnostic system: reading out fault memory and activating systems

- Make sure that the wiring harness is not twisted through the door opening when fitted.

2. Push the wiring harness from the inside through the door aperture and press in the rubber grommet on the wiring harness from inside into the door aperture.

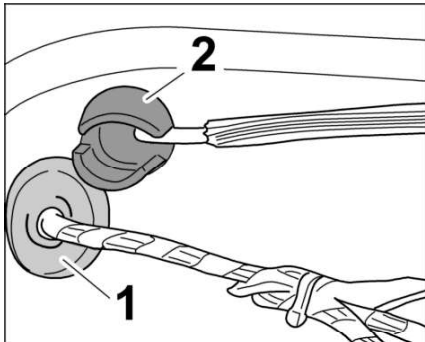

Installing rubber grommets

3. Install the rubber grommet for electric lead -1- and bowden cable -2- in the unit carrier until this engages all the way around.

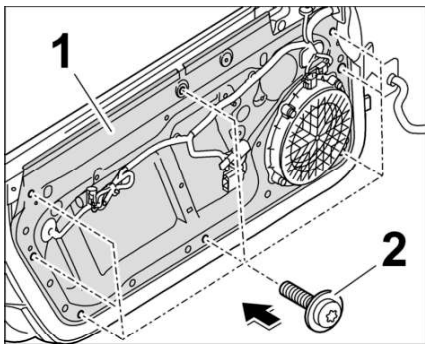

Fastening door unit carrier

4. Screw down fastening screws -2- for the door unit carrier -1-. Tightening torque **Final tightening: 9.7 (7.2) Nm (ftlb.)**

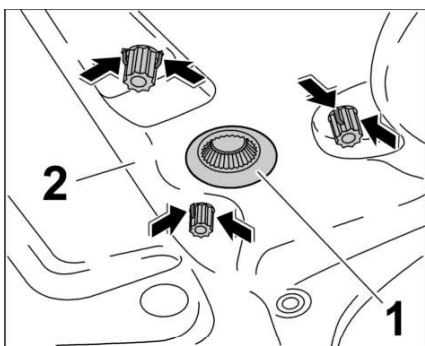

Clipping in power windows

5. Clip in power windows -1- on door unit carrier -2-.

Locking electrical plug connection

Installation Location:

Locking electrical plug connection

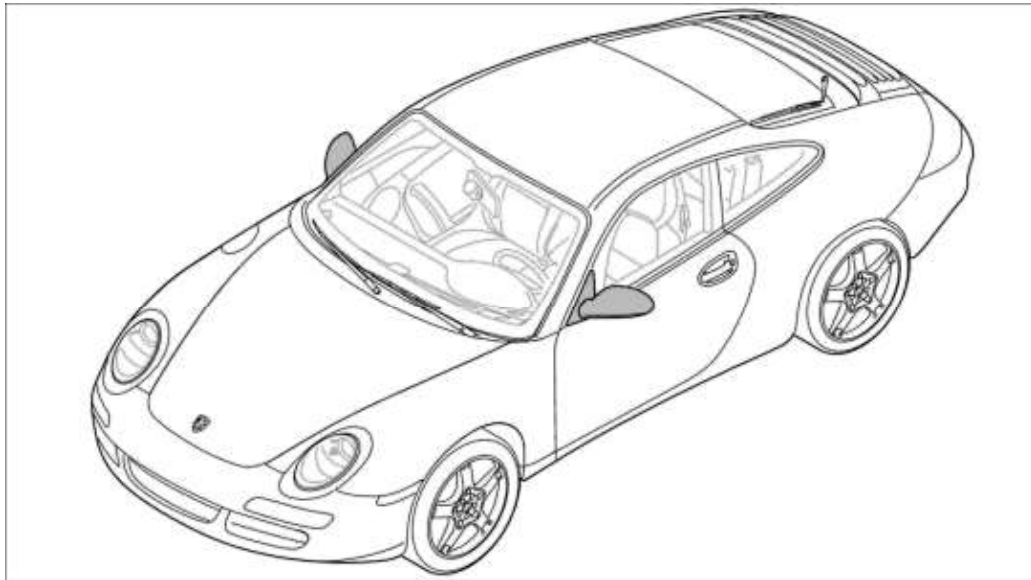

Overview, removing and installing rear-view mirror

1. Connect the plug connection of the mirror housing **-3-**.

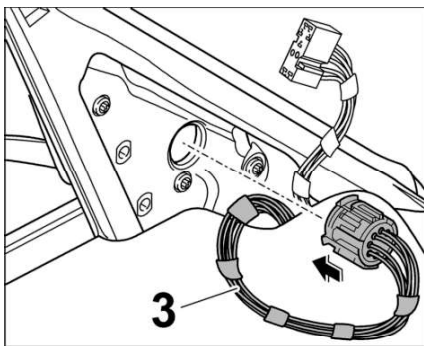

Locking plug connection

Fitting seal for mirror triangle

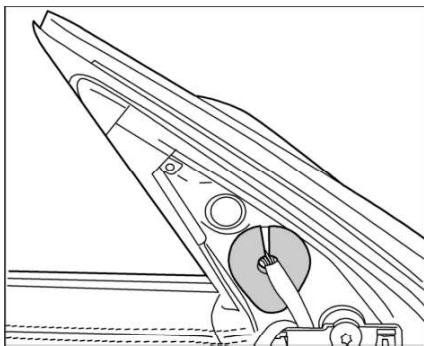

Seal for mirror triangle

1. Stick seal for mirror triangle at cable cutout opening on door mirror to the basic door frame.