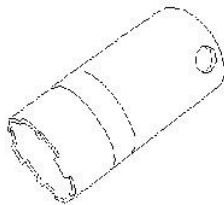

The present document was valid at the time of print. A later version may be available online

## **WM 280419 Removing and installing ignition switch**

**Tools**

Designation	Type	Number	Description	
Wrench	VW tool	T10152		<div style="text-align: center;">  <p>28</p> <p>T10152</p> </div>

**Technical values**

Location	Description	Type	Basic value	Tolerance 1	Tolerance 2
Union nut on ignition switch		Tightening torque	1.6 Nm		

**Removing ignition switch**

**Removing ignition switch**

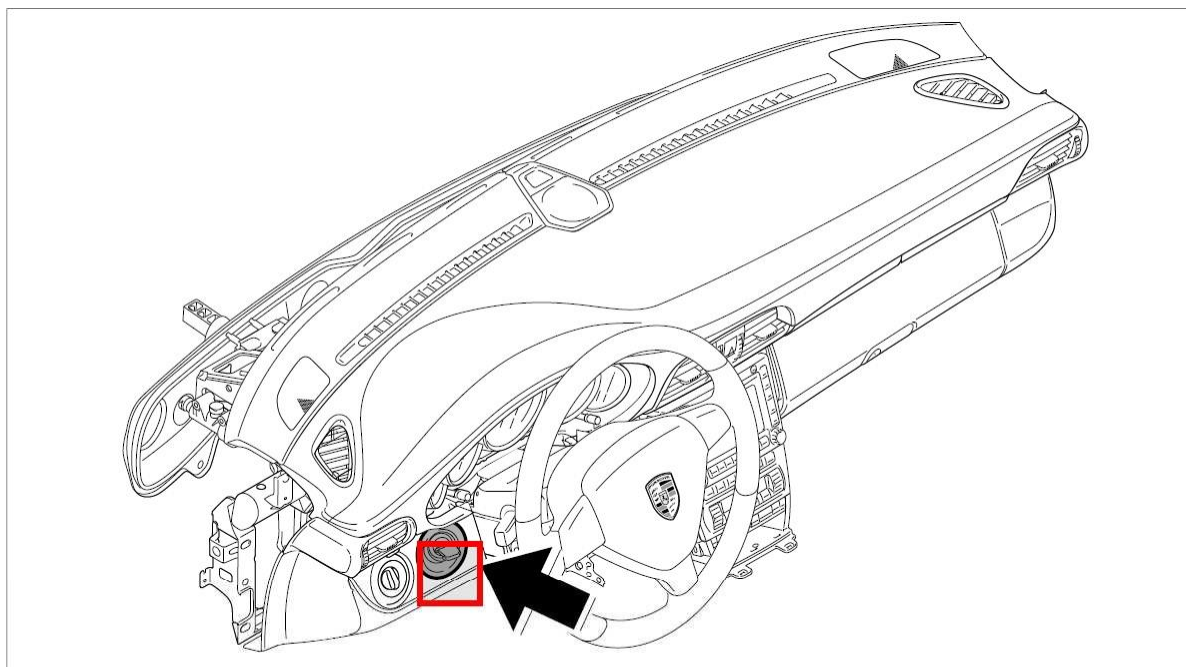

*Installation position*

1. Carefully lift up rubber sleeve on the ignition switch using a plastic spatula, for example, and remove it.

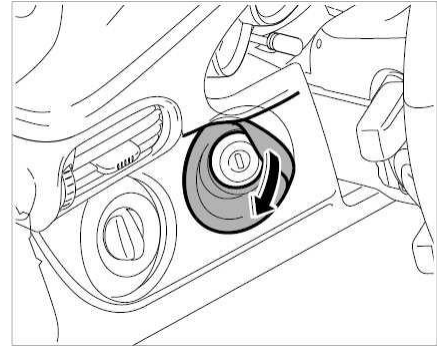
*Removing detachable cover*

2. Turn union nut using a narrow plastic spatula, for example, or using the special **wrench T10152** tool and unscrew the ring from the ignition starter switch.

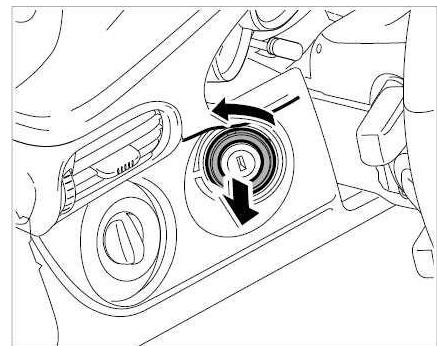
*Unscrewing union nut from ignition switch*

3. Press ignition switch inwards and remove towards the bottom.
4. Release electric connector **-a-** and pull it off the ignition starter switch.

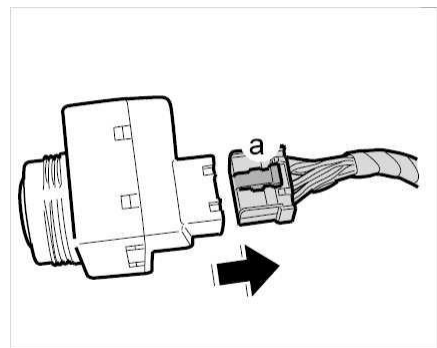
*Releasing and pulling off electric plug*

## Installing ignition switch

### Installing ignition switch

1. Connect plug on ignition switch until it clicks into place.

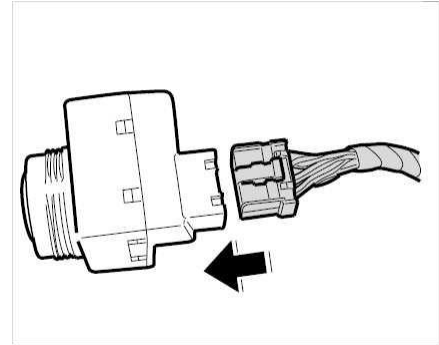

*Connecting electric plug*

2. Position ignition switch in the switch panel from below. Position union nut, re-adjust switch and tighten union nut using **wrench T10152**. → **Tightening torque: 1.6 Nm**

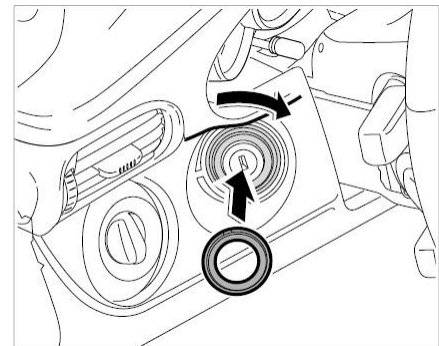

*Turning union nut on ignition switch*

3. Place cover in position and slide it over the ignition switch, paying attention to the fitted shape.

## Information

### Emergency operation of the ignition key lock



#### Information

*In the event of insufficient or non-existent battery positive voltage, the ignition key can be removed using the emergency operation.*

1. Lever out the small cover, at the top right next to the ignition key, at the ignition switch using a screwdriver.

2. Then, push a pen, for example, into the opening next to the key, turn the ignition key to position 0 and pull it out.
-