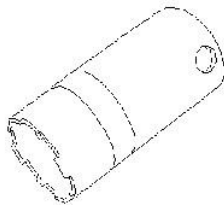

The present document was valid at the time of print. A later version may be available online

WM 280419 Removing and installing ignition switch

Tools

| Designation | Type | Number | Description | |
|-------------|---------|--------|-------------|--|
| Wrench | VW tool | T10152 | | <div style="text-align: center;">  <p>28</p> <p>T10152</p> </div> |

Technical values

| Location | Description | Type | Basic value | Tolerance 1 | Tolerance 2 |
|------------------------------|-------------|-------------------|-------------|-------------|-------------|
| Union nut on ignition switch | | Tightening torque | 1.6 Nm | | |

Removing ignition switch

Removing ignition switch

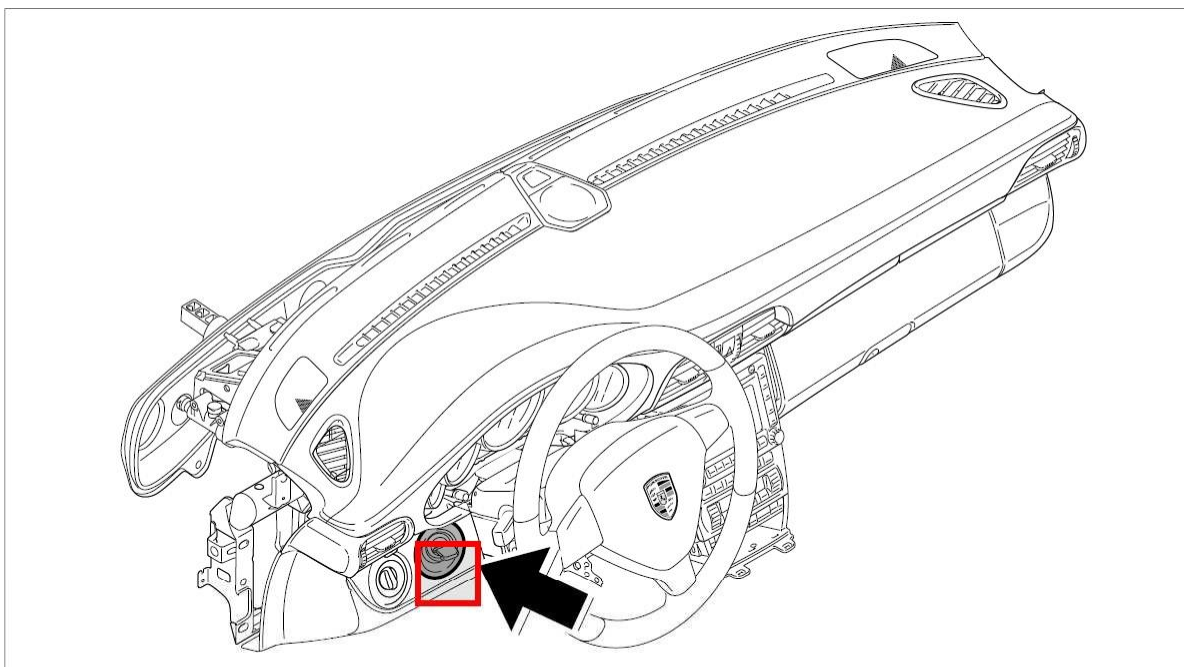

Installation position

1. Carefully lift up rubber sleeve on the ignition switch using a plastic spatula, for example, and remove it.

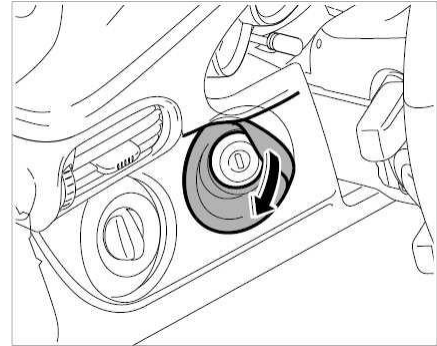
*Removing detachable cover*

2. Turn union nut using a narrow plastic spatula, for example, or using the special **wrench T10152** tool and unscrew the ring from the ignition starter switch.

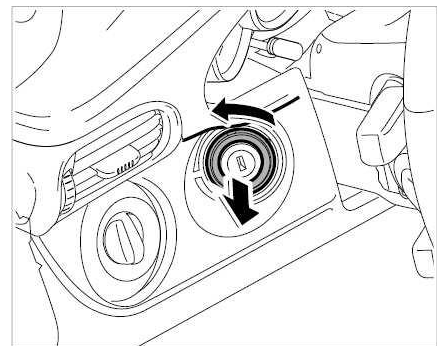
*Unscrewing union nut from ignition switch*

3. Press ignition switch inwards and remove towards the bottom.
4. Release electric connector **-a-** and pull it off the ignition starter switch.

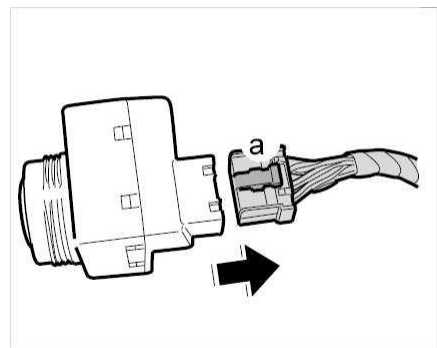
*Releasing and pulling off electric plug*

Installing ignition switch

Installing ignition switch

1. Connect plug on ignition switch until it clicks into place.

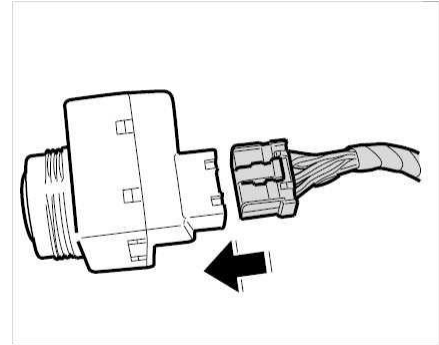

Connecting electric plug

2. Position ignition switch in the switch panel from below. Position union nut, re-adjust switch and tighten union nut using **wrench T10152**. → **Tightening torque: 1.6 Nm**

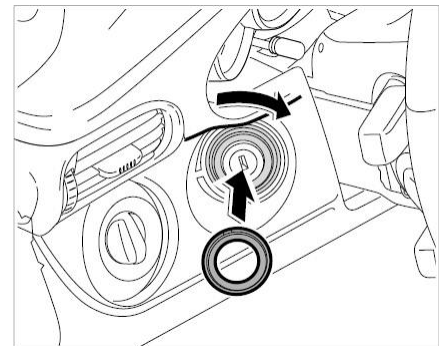

Turning union nut on ignition switch

3. Place cover in position and slide it over the ignition switch, paying attention to the fitted shape.

Information

Emergency operation of the ignition key lock



Information

In the event of insufficient or non-existent battery positive voltage, the ignition key can be removed using the emergency operation.

1. Lever out the small cover, at the top right next to the ignition key, at the ignition switch using a screwdriver.

2. Then, push a pen, for example, into the opening next to the key, turn the ignition key to position 0 and pull it out.
-