

## Dismantling and assembling suspension

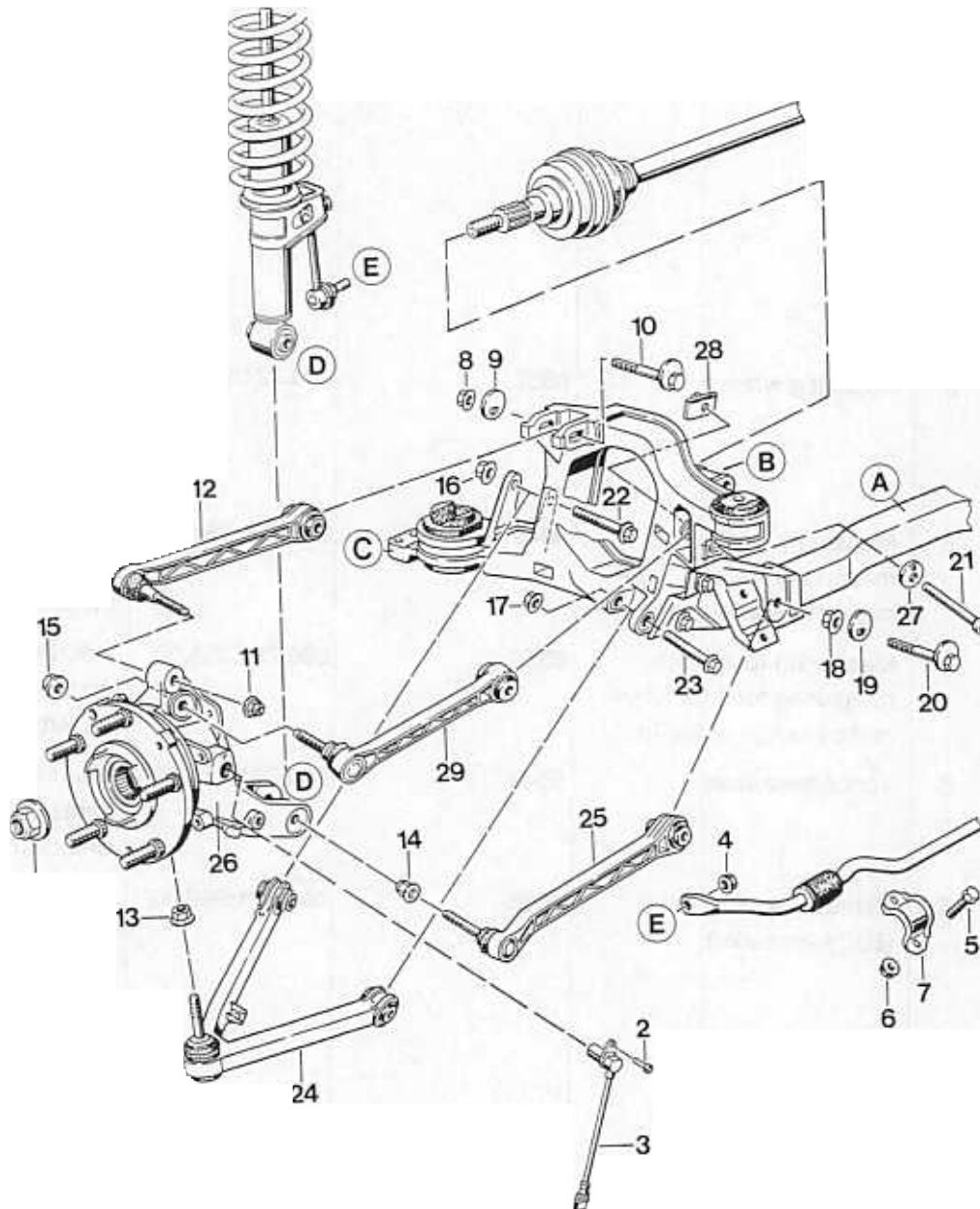

**A = Rear crossmember**

**B / C = Upper or front crossmember mount**

To ensure clarity, the front crossmember (C area) and the upper crossmember (B area) are not marked. These components as well as the rear crossmember (A) do not have to be removed.

No.	Designation	Qty.	Note:	
			Removal	Installation
1	Lock nut	1	Actuate the brakes when undoing the lock nut.	Replace. Coat threads, nut support face and drive shaft splines with Optimoly HT. Tighten to 460 Nm (340 ftlb.)
2	Pan-head screw	1		Tighten to 10 Nm (7 ftlb.)
3	Rpm sensor	1		Coat stem with Molykote Longterm
4	Lock nut M 10	1	Use an open-ended wrench to lock at ball joint of stabilizer mount	Replace. Tighten to 46 Nm ((34 ftlb.)
5	Hexagon head bolt	2		
6	Lock nut	2		Replace. Tighten to 23 Nm (17 ftlb.)
7	Retaining bracket	1		
8	Lock nut M 12	1	Mark position of camber eccentric (No. 10) for reinstallation before undoing the lock nut	Replace. Tightening torque 85 Nm (63 ftlb.). Also observe item 5 on page 42 - 14.
9	Eccentric washer	1		
10	Camber eccentric	1		Observe items 2 and 5 on page 42 - 13/14. Install in same position as before removal (acc. to markings)
11	Lock nut	1		Replace. Tighten to 75 Nm (55 ftlb.).
12	Control arm 3 (camber arm)	1		No welding and straightening is permitted on this component
13	Lock nut M 12	1	Start by slackening only. Observe assembly notes on page 42 - 11/12.	Replace. Tighten to 75 Nm (55 ftlb.).

No.	Designation	Qty.	Note:	
			Removal	Installation
14	Lock nut M 12	1	Start by slackening only. Observe assembly notes on page 42 - 11/12.	Replace. Tighten to 85 Nm (63 ftlb.).
15	Lock nut M 12	1	Start by slackening only. Observe assembly notes on page 42 - 11/12.	Replace. Tighten to 75 Nm (55 ftlb.).
16	Lock nut M 14	1		Replace. Tighten to 200 Nm (147 ftlb.).
17	Lock nut M 12	1		Replace. Tighten to 85 Nm (63 ftlb.). Tighten in zero position only (page 44 - 14)
18	Lock nut M 12	1	Mark position of toe eccentric (No. 20) relative to crossmember before undoing	Replace. Tightening torque 100 Nm (74 ftlb.). Also observe item 5 on page 42 - 14.
19	Eccentric washer	1		
20	Toe eccentric	1		Observe items 2 and 5 on page 42 - 13/14. Install in same position as before removal (acc. to markings)
21	Pan-head screw M 12	1	Mark position of eccentric washer (No. 27) before undoing the screw. Start by slackening only. Observe assembly notes on page 42 - 12.	Tightening torque 85 Nm (63 ftlb.). Also observe item 5 on page 42 - 14
22	Hexagon head bolt M 14	1		
23	Hexagon head bolt M 12	1		
24	Control arm 1/5	1		No welding and straightening is permitted on this component.

No.	Designation	Qty.	Note:	
			Removal	Installation
25	Control arm 2 (camber arm)	1		No welding and straightening is permitted on this component.
26	Wheel carrier	1		Tapers of control arm 1/5, arm 3 and arm 4 to wheel carrier and control arm must be grease-free
27	Eccentric washer	1		Install in same position as before removal (acc. to markings).
28	Captive nut	1		
29	Control arm 4	1		No welding and straightening is permitted on this component.