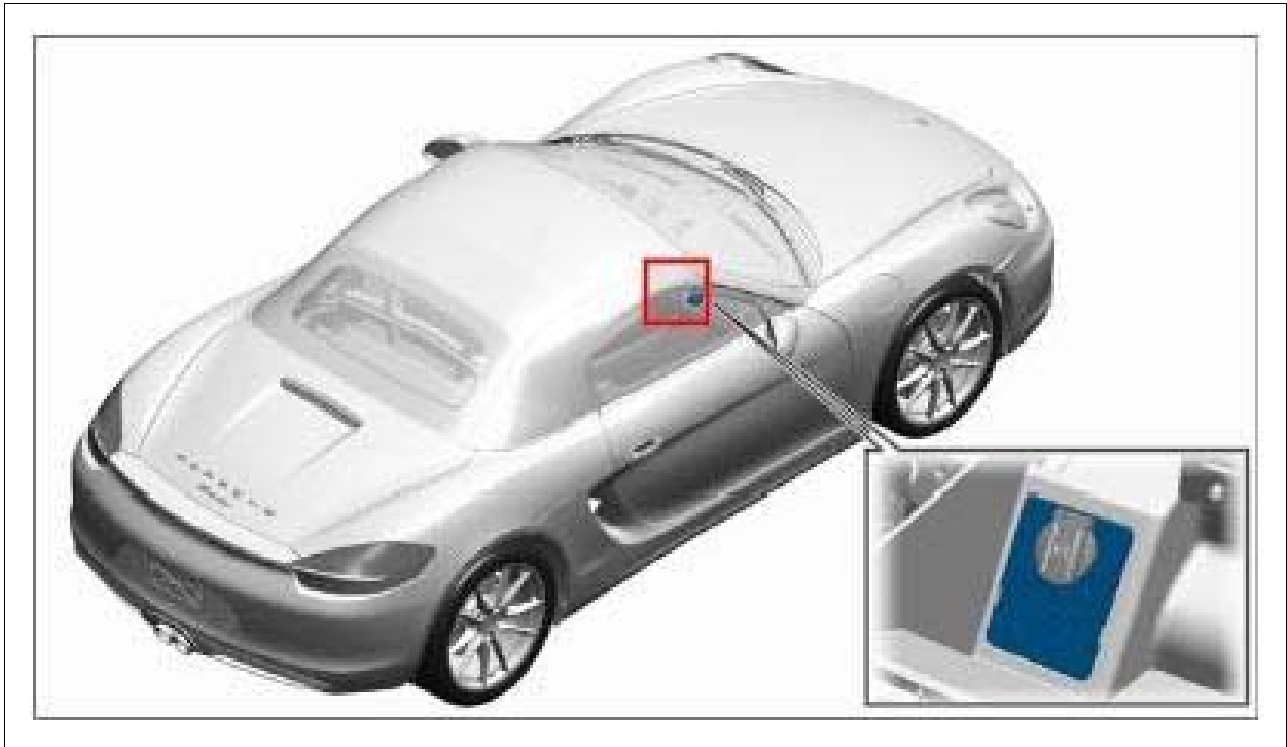

Fig 1: Identifying Multimedia Interface Position



Courtesy of PORSCHE CARS NORTH AMERICA, INC.

1. Insert screwdriver at an angle into the notch **-arrow-** and turn to the left to lift out the multimedia interface.

Fig 2: Removing Multimedia Interface

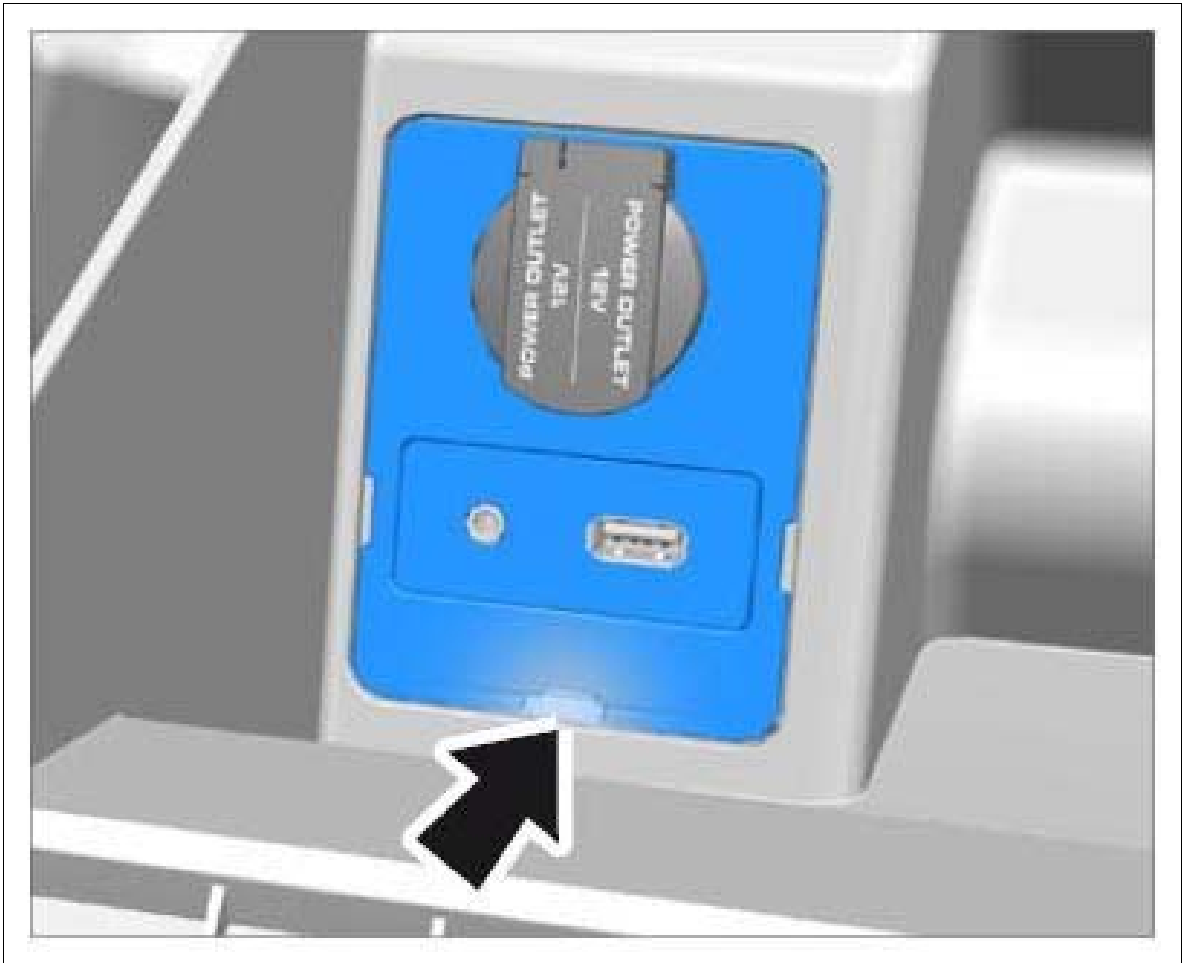

Courtesy of PORSCHE CARS NORTH AMERICA, INC.

2. Unplug electric plug connections for the multimedia interface.

1. 2.1. Cut tie-wrap **-A-** .
2. 2.2. Disconnect electric plug connection for 12 V supply **-B-** .
3. 2.3. Release mounting for USB interface **-C-** close to the locking lug and disconnect the USB interface.
4. 2.4. Release mounting for jack socket **-D-** close to the locking lug and disconnect jack socket.

Fig 3: Disconnecting Electric Plug Connections

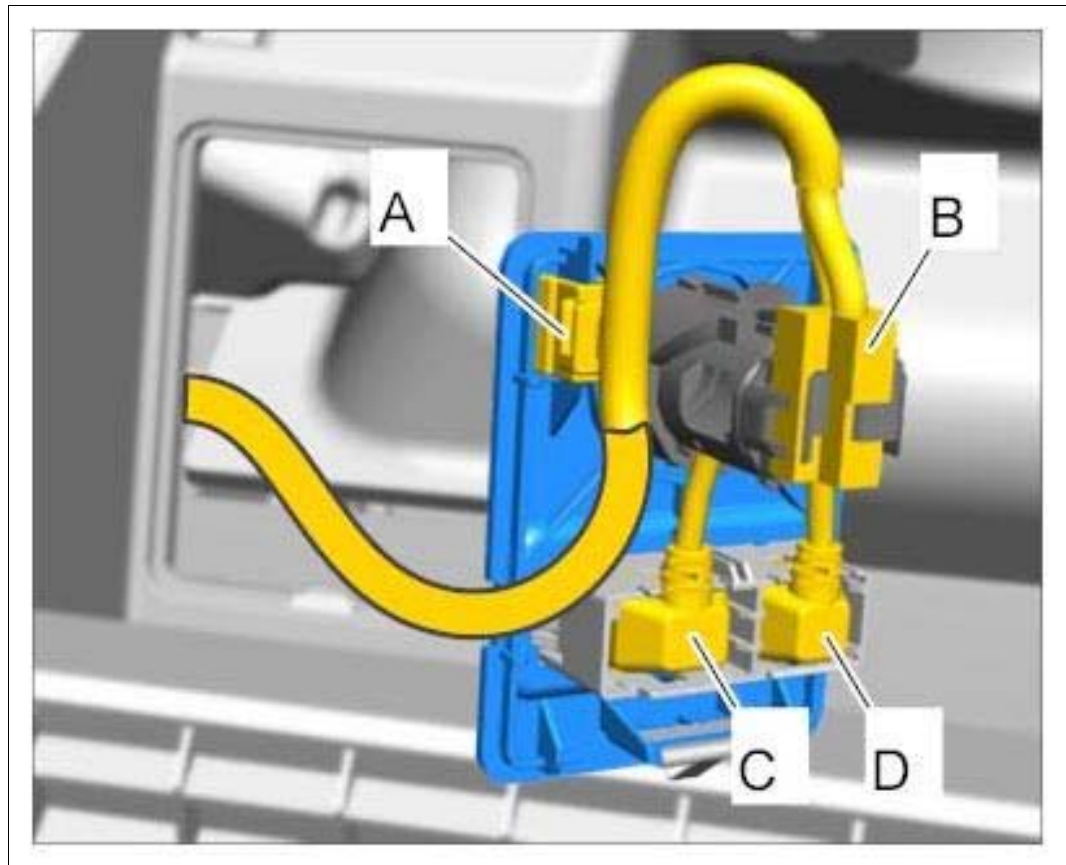

Courtesy of PORSCHE CARS NORTH AMERICA, INC.

## WM 912219 REMOVING AND INSTALLING MULTIMEDIA INTERFACE (ALL MODELS) > INSTALLING MULTIMEDIA INTERFACE

1. Plug in electric plug connections for the multimedia interface.
  1. 1.1. Insert jack socket **-D-** into the mounting until the jack socket locks into place.
  2. 1.2. Insert USB interface **-C-** into the mounting until the USB interface locks into place.
  3. 1.3. Connect plug connection for 12 V supply **-B-** until the connector engages securely.
  4. 1.4. Secure the line with a tie-wrap **-A-** .

Fig 2: Securing Electric Plug Connection

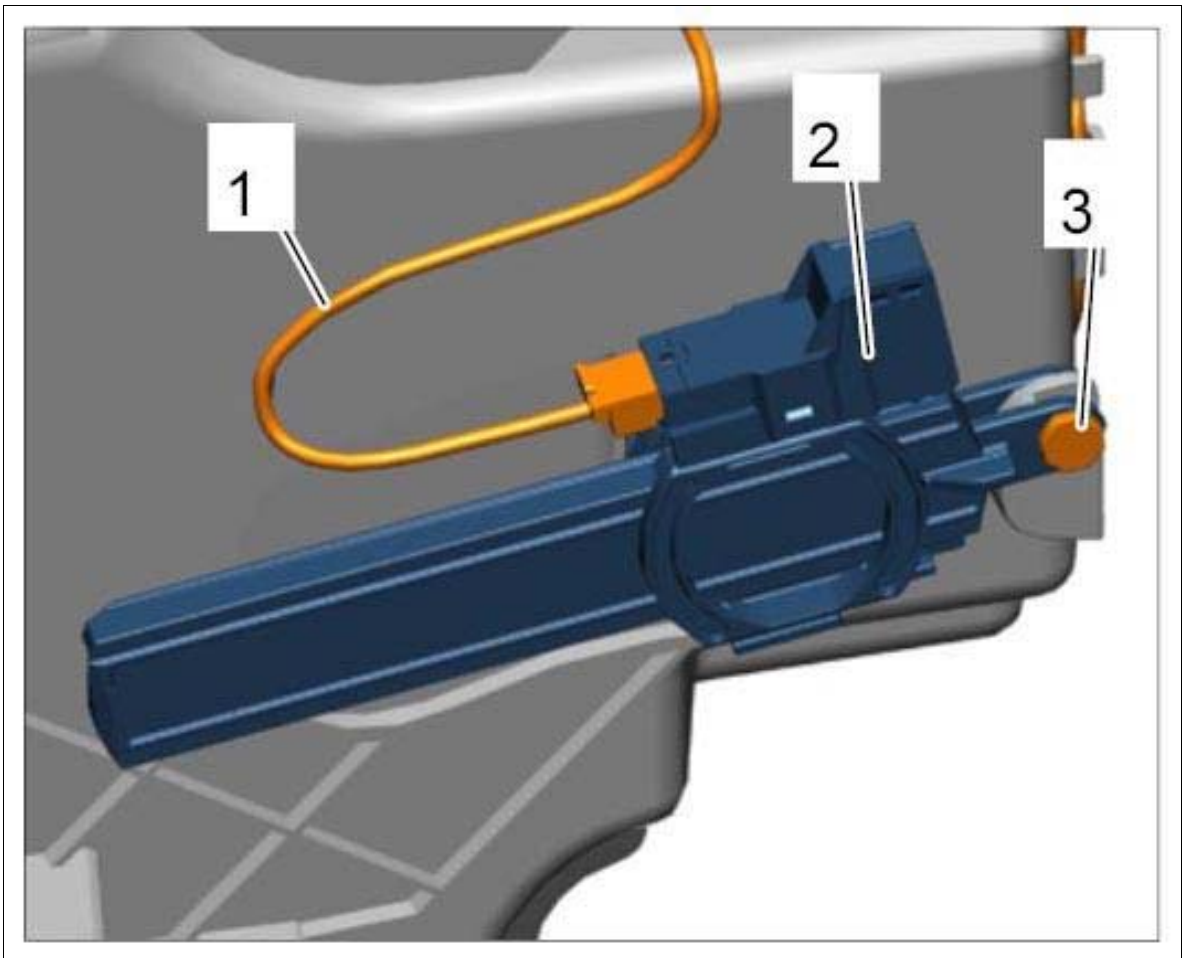

Courtesy of PORSCHE CARS NORTH AMERICA, INC.

**WM 960719 REMOVING AND INSTALLING CONTACT SWITCH FOR GLOVE BOX LIGHT (ALL MODELS) > SUBSEQUENT WORK**

Install glove compartment. → 681519 REMOVING AND INSTALLING GLOVE COMPARTMENT - section on "Installing"

**WM 961519 REMOVING AND INSTALLING FOOTWELL LIGHT (ALL MODELS) > REMOVING FOOTWELL LIGHT**

Fig 1: Identifying Footwell Lights Installation Position

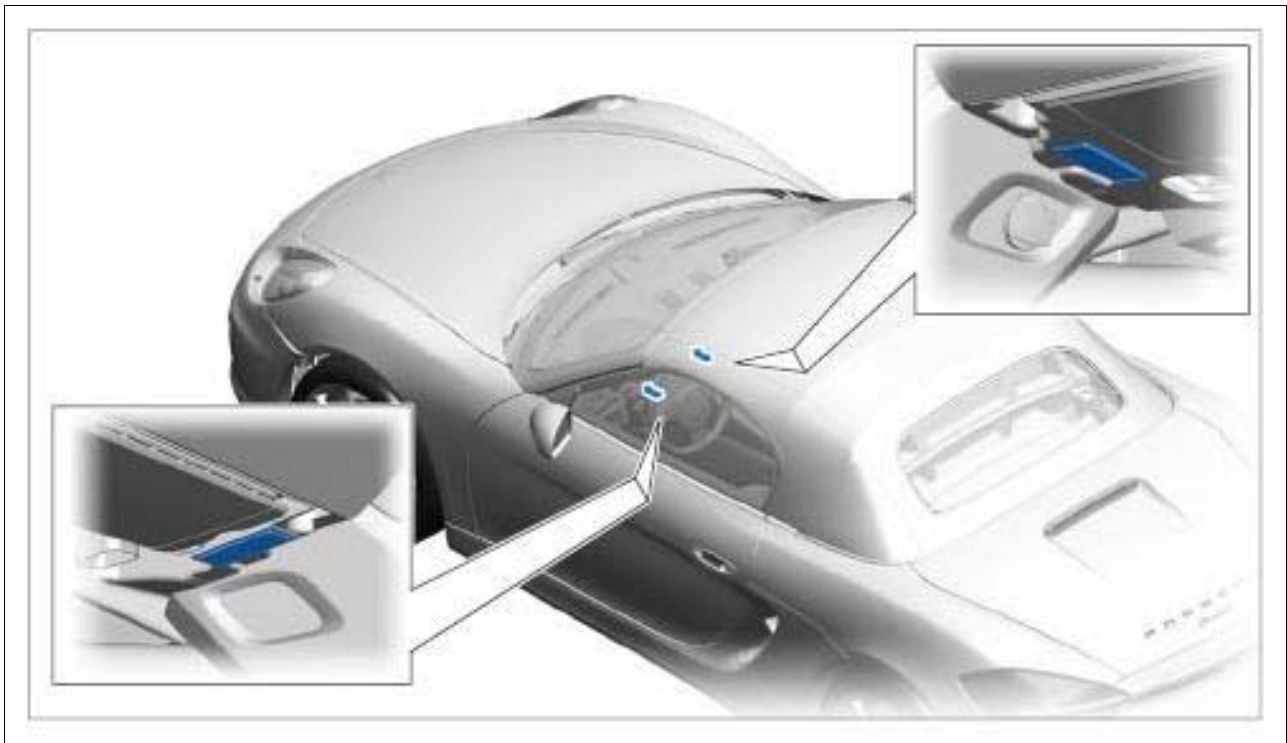

Courtesy of PORSCHE CARS NORTH AMERICA, INC.

1. Press footwell light carefully out of the trim panel at the cut-out **-A-** using a screwdriver.

Fig 2: Unclipping Footwell Light

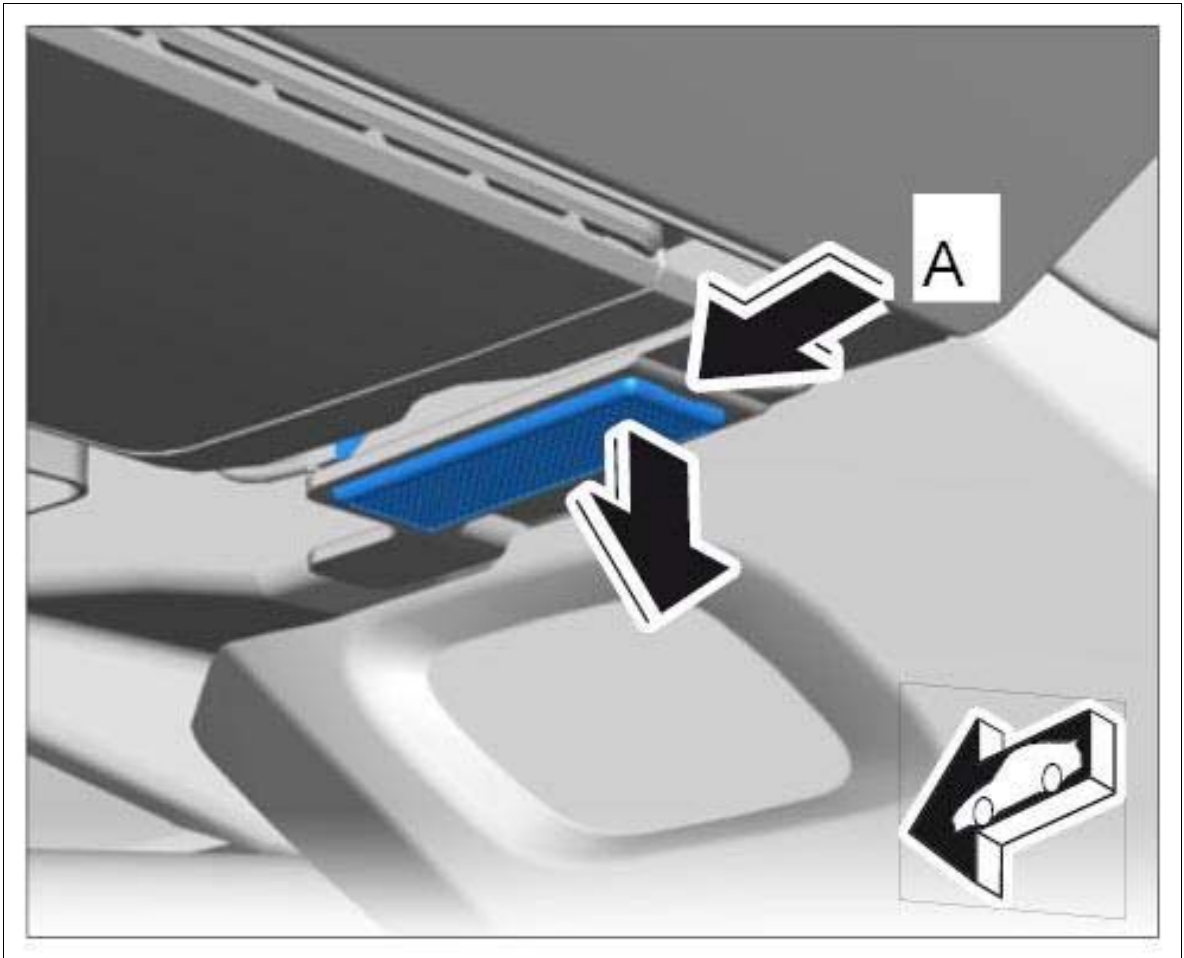

Courtesy of PORSCHE CARS NORTH AMERICA, INC.

2. Unplug electric plug connection **-arrow-** for footwell light.

Fig 3: Unplugging Electric Plug Connection

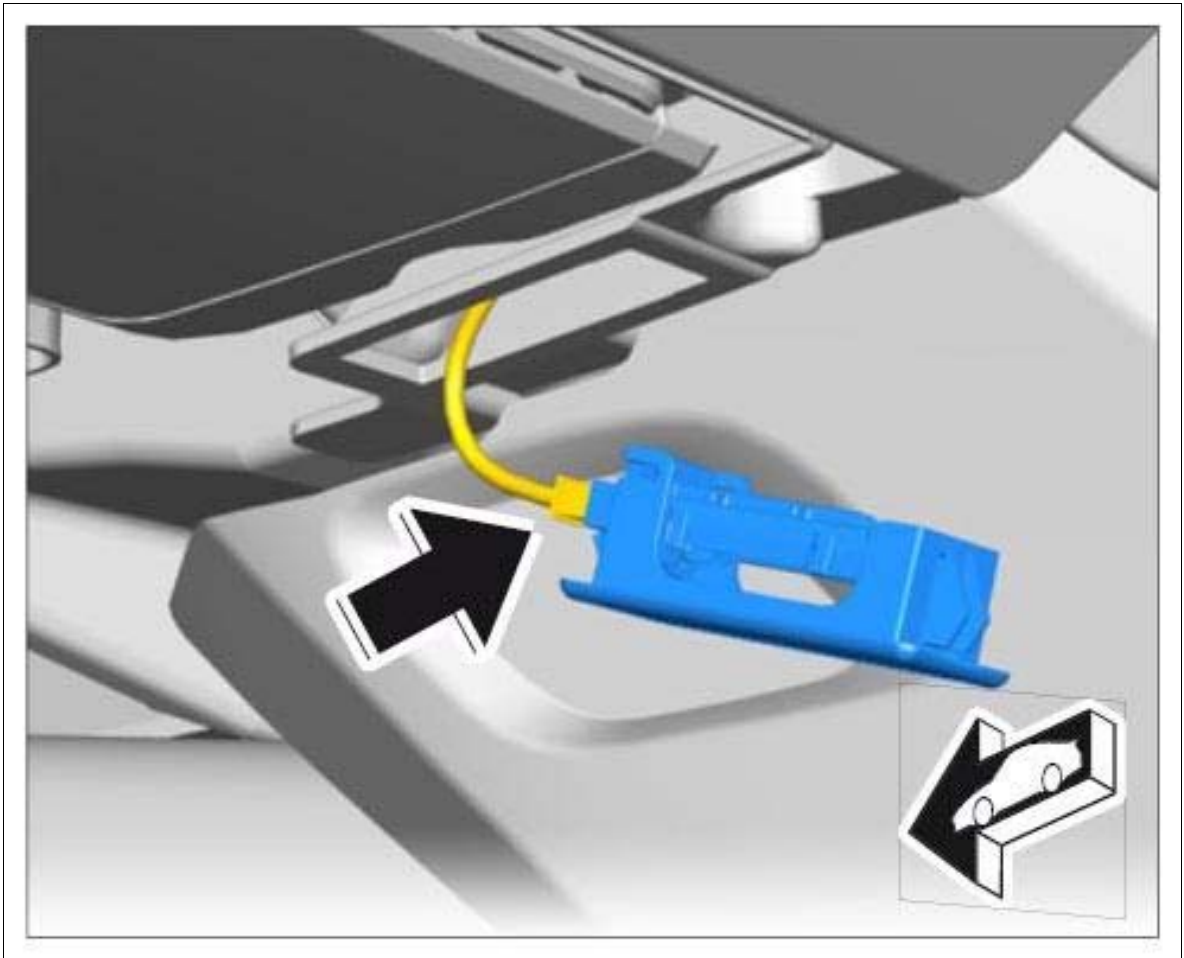

Courtesy of PORSCHE CARS NORTH AMERICA, INC.

## WM 961519 REMOVING AND INSTALLING FOOTWELL LIGHT (ALL MODELS) > INSTALLING FOOTWELL LIGHT

1. Connect electric plug connection **-arrow-** for footwell light until the connector engages securely.

## MODELS) > TECHNICAL VALUES

Location	Description	Type	Basic Value	Tolerance 1	Tolerance 2
Fastening Screw Securing Footwell Outlet Vent Trim		Tightening Torque	3.2 Nm (2 ft. lbs.)	+/-0.3 Nm (+/- 0.2 ft. lbs.)	

## WM 681419 REMOVING AND INSTALLING CENTER CONSOLE COVER (ALL MODELS) > REMOVING CENTER CONSOLE COVER

Fig 1: Identifying Center Console Cover Installation Position

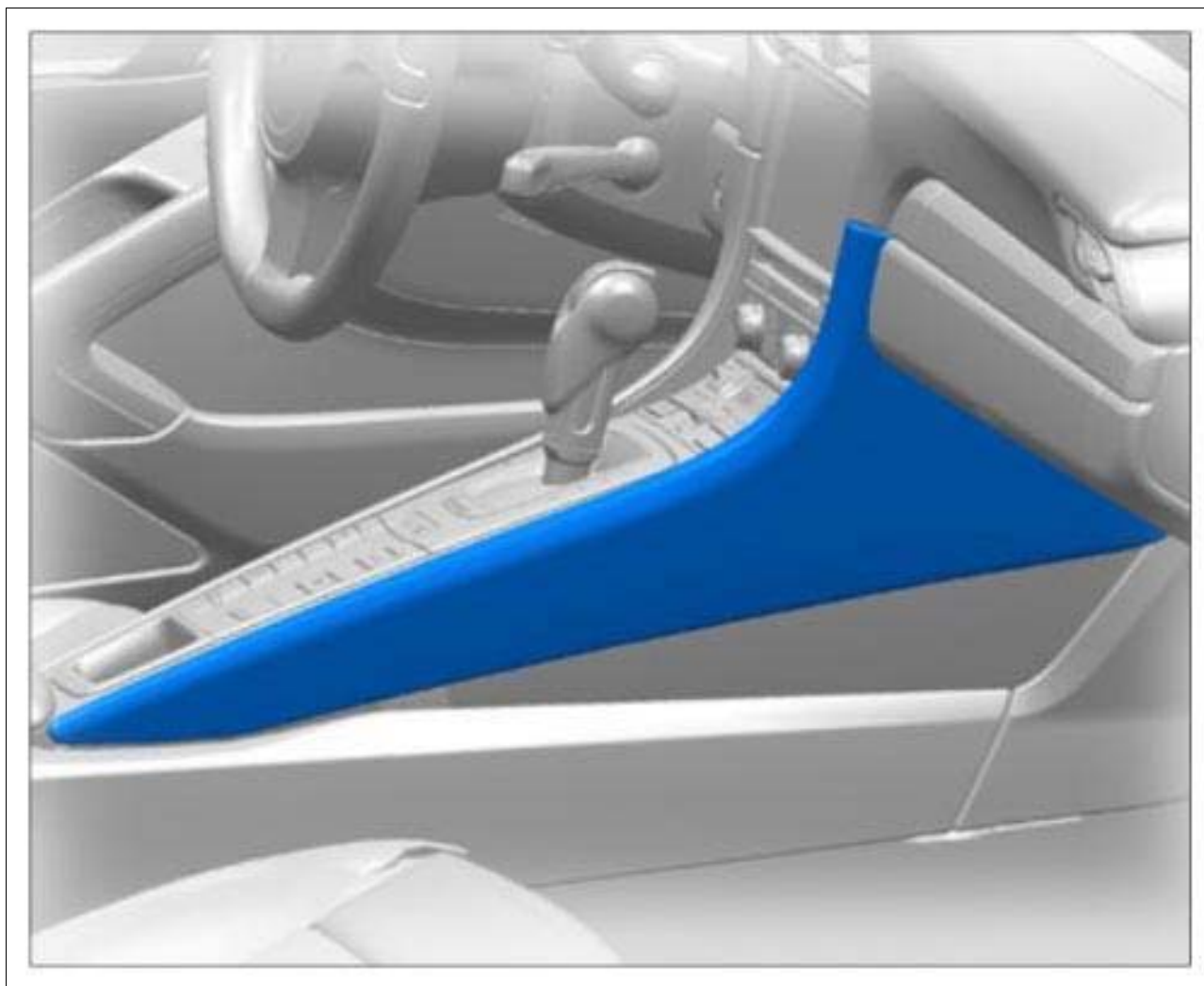

Courtesy of PORSCHE CARS NORTH AMERICA, INC.

1. Unclip side trim panel to the side **-arrow-**



Fig 2: Unclipping Side Trim Panel

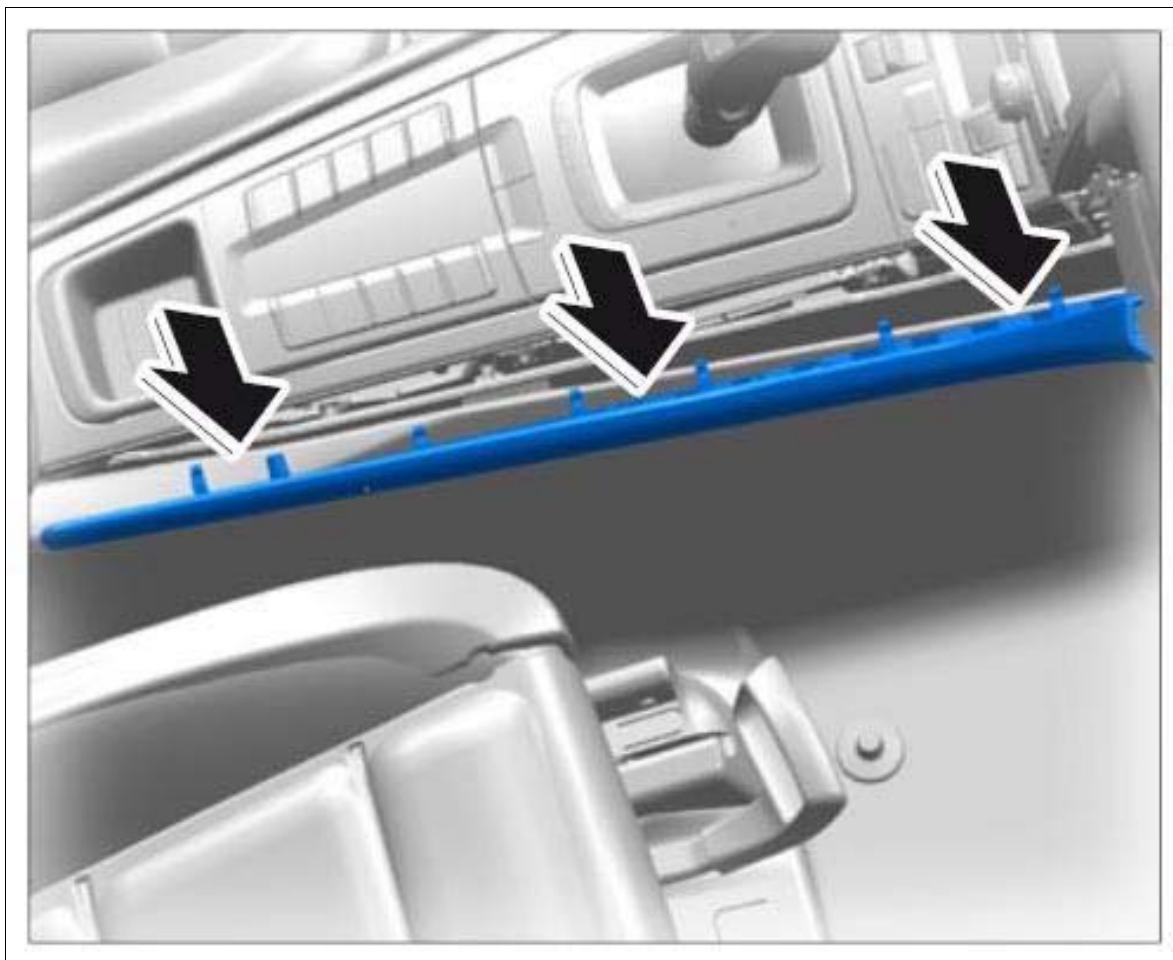

Courtesy of PORSCHE CARS NORTH AMERICA, INC.

2. Pull the side trim panel back out of the guide **-arrow-** .

Fig 3: Removing Side Trim Panel



Courtesy of PORSCHE CARS NORTH AMERICA, INC.

3. Unscrew fastening screw -1- on the footwell outlet vent trim -2- .

Fig 4: Detaching Footwell Outlet Vent Trim

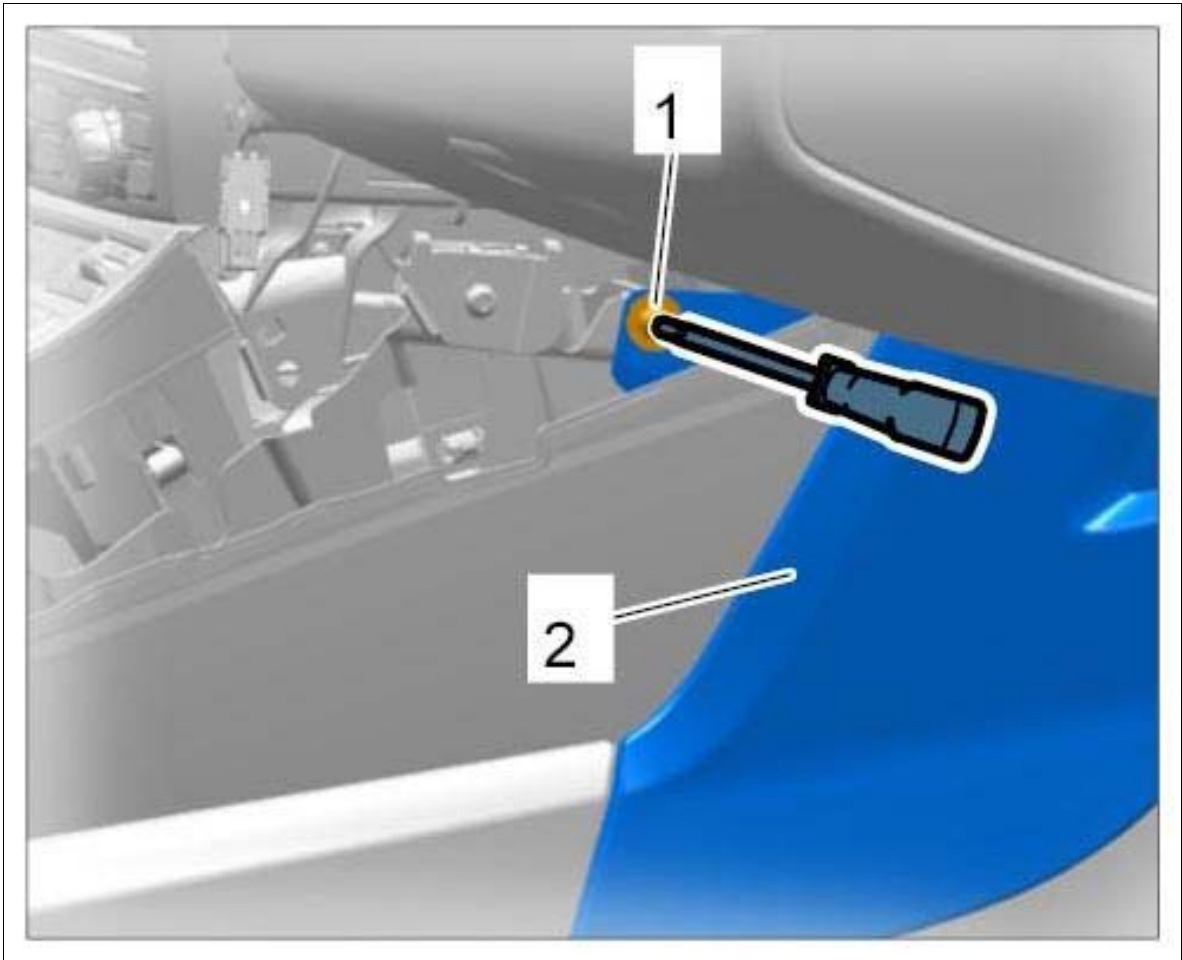

Courtesy of PORSCHE CARS NORTH AMERICA, INC.

4. Remove footwell outlet vent trim.

1. 4.1. Guide footwell outlet vent trim **-1-** forward **-arrow A-** out of the guide **-2-** .

2. 4.2. Remove footwell outlet vent trim in a downward direction **-arrow B-** .

Fig 5: Removing Footwell Outlet Vent Trim

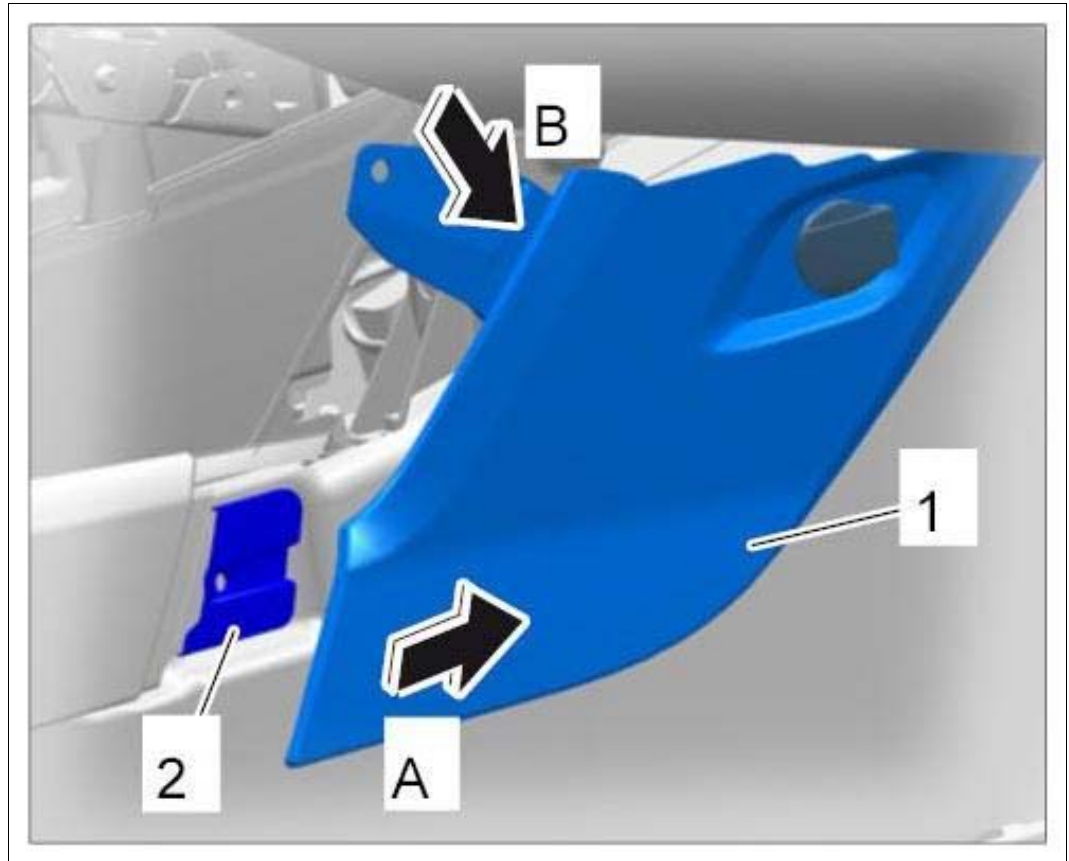

Courtesy of PORSCHE CARS NORTH AMERICA, INC.

5. Release electric plug connection -1- on the passenger's side and pull it off -arrow- .

Fig 6: Disconnecting Electric Plug Connection

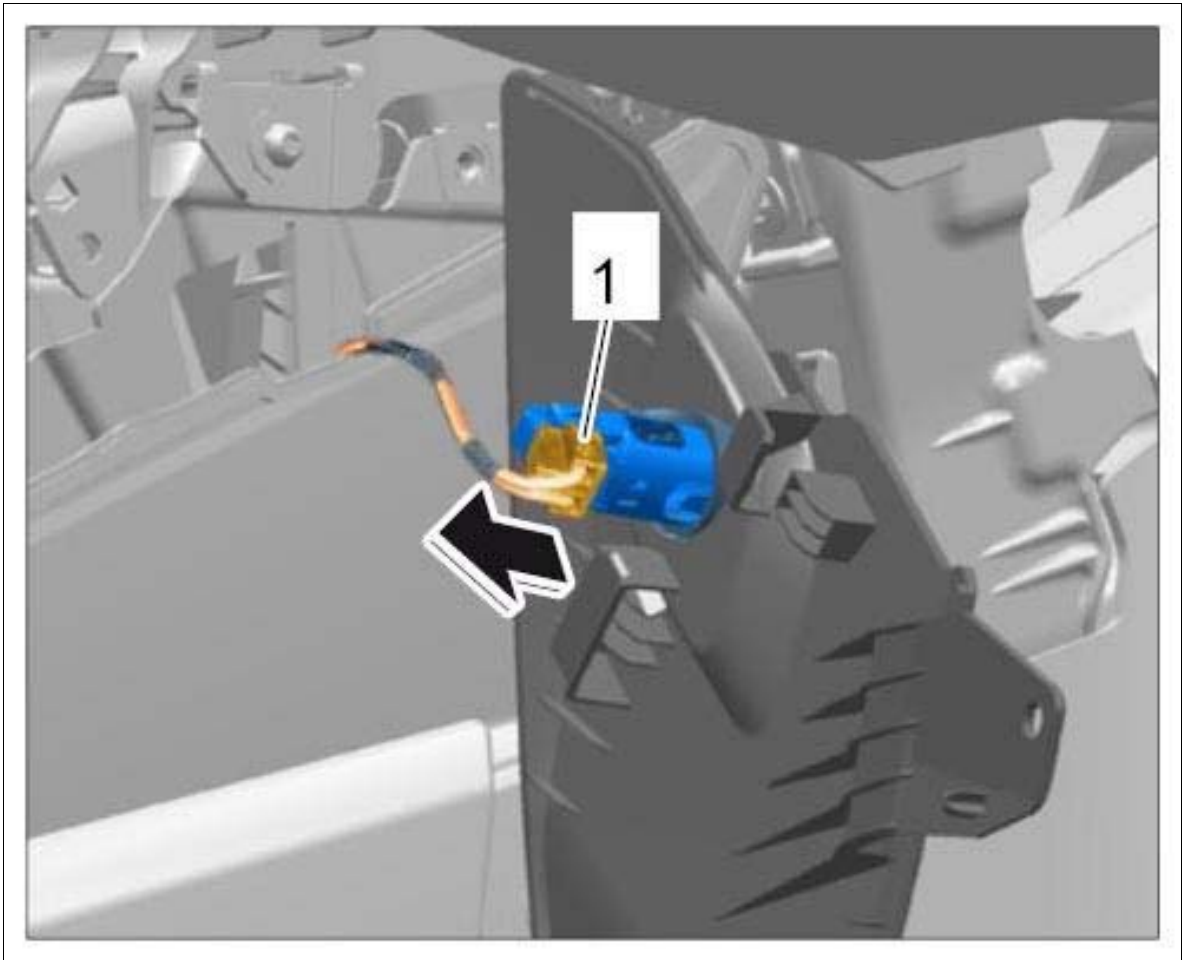

Courtesy of PORSCHE CARS NORTH AMERICA, INC.

**WM 681419 REMOVING AND INSTALLING CENTER CONSOLE COVER (ALL MODELS) > INSTALLING CENTER CONSOLE COVER**

1. Installation is performed in reverse order to removal.
2. Tighten fastening screw on the footwell outlet vent trim to the specified tightening torque.  
**Tightening Torque 3.2 Nm (2 ft. lbs.) +/-0.3 Nm (+/-0.2 ft. lbs.)**

**WM 681519 REMOVING AND INSTALLING GLOVE COMPARTMENT (ALL MODELS) > TECHNICAL VALUES**

Location	Description	Type	Basic Value	Tolerance 1	Tolerance 2
Fastening Screws For Glove Compartment, Top		Tightening Torque	3.2 Nm (2 ft. lbs.)		

Fastening Screws For Glove Compartment, Bottom		Tightening Torque	13 Nm (9.5 ft. lbs.)		
Fastening Screw For Glove Compartment, Side		Tightening Torque	3.2 Nm (2 ft. lbs.)		

## **WM 681519 REMOVING AND INSTALLING GLOVE COMPARTMENT (ALL MODELS) > PRELIMINARY WORK**

1. Remove right center console cover. → 681419 REMOVING AND INSTALLING CENTER CONSOLE COVER
2. Remove right cupholder. → 683019 REMOVING AND INSTALLING CUPHOLDER
3. Remove dashboard trim panel at the right. → 701619 REMOVING AND INSTALLING DASHBOARD TRIM PANEL ON PASSENGER'S SIDE
4. Remove right footwell light. → 961519 REMOVING AND INSTALLING FOOTWELL LIGHT
5. Remove multimedia interface. → 912219 REMOVING AND INSTALLING MULTIMEDIA INTERFACE

## **WM 681519 REMOVING AND INSTALLING GLOVE COMPARTMENT (ALL MODELS) > REMOVING GLOVE COMPARTMENT**

1. Unscrew the fastening screw at the side -1- .

Fig 1: Loosening Mounting At Side

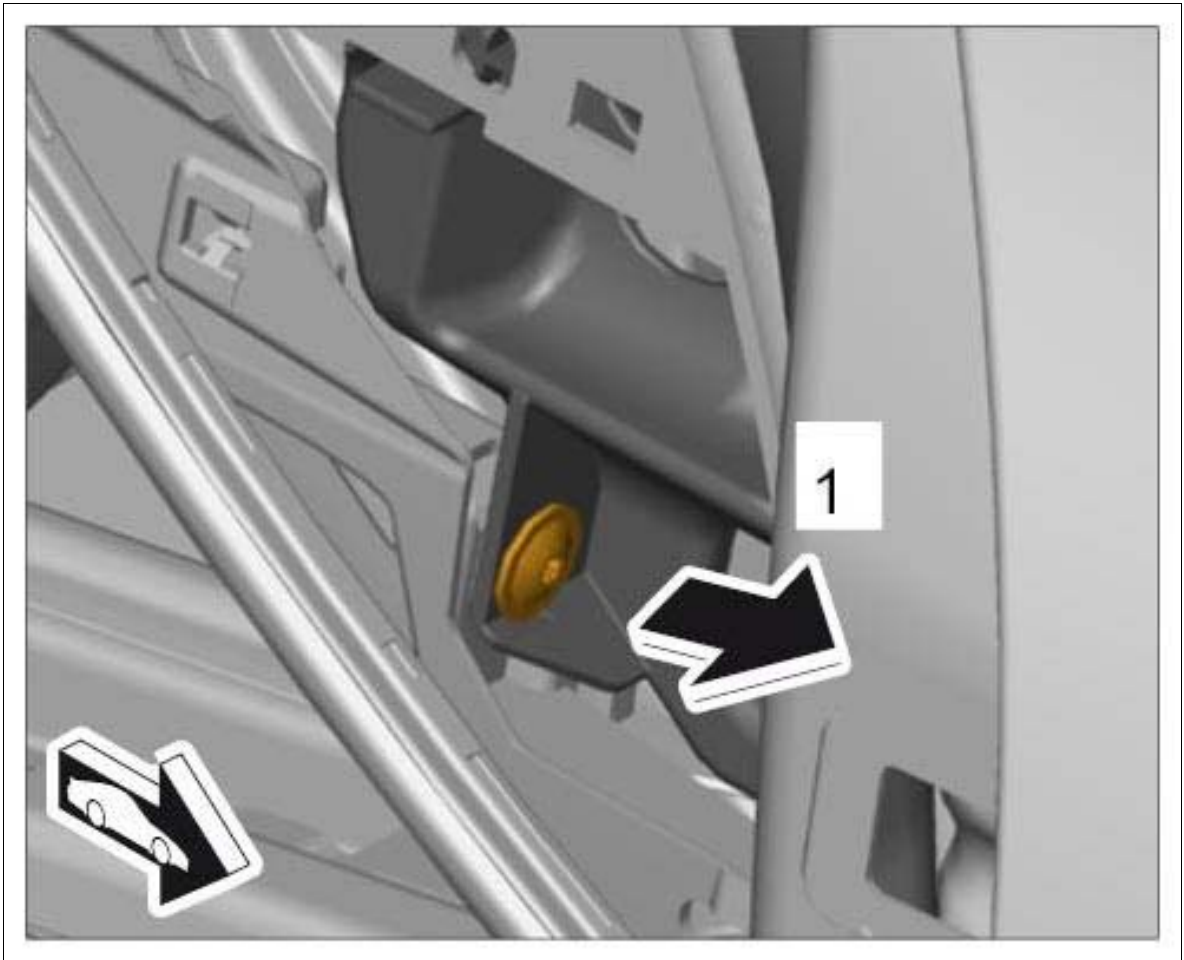

Courtesy of PORSCHE CARS NORTH AMERICA, INC.

2. Unscrew the fastening screws at the bottom -1- .

Fig 2: Loosening Mounting At Bottom

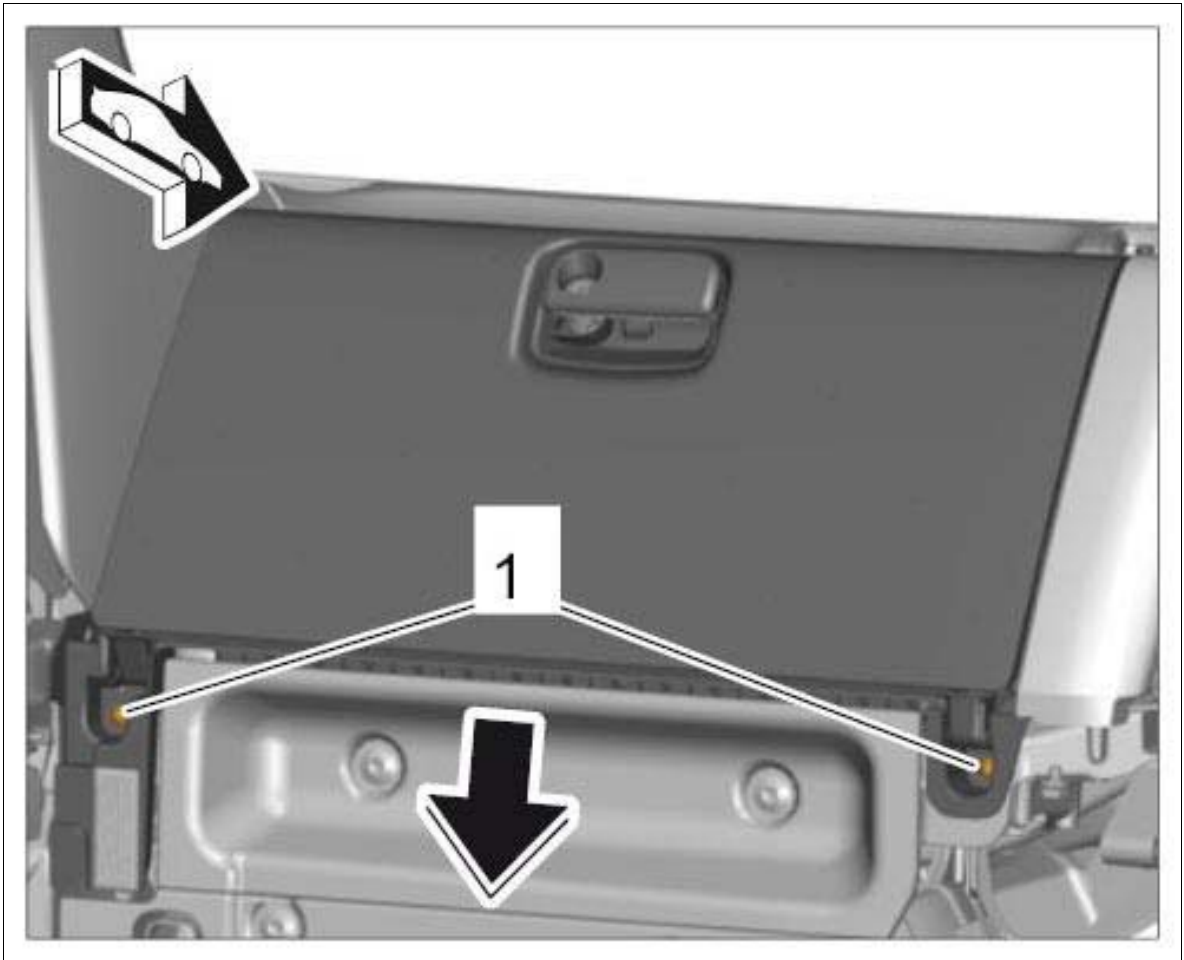

Courtesy of PORSCHE CARS NORTH AMERICA, INC.

3. Unscrew the fastening screws at the top -1- .



Fig 3: Loosening Mounting At Top

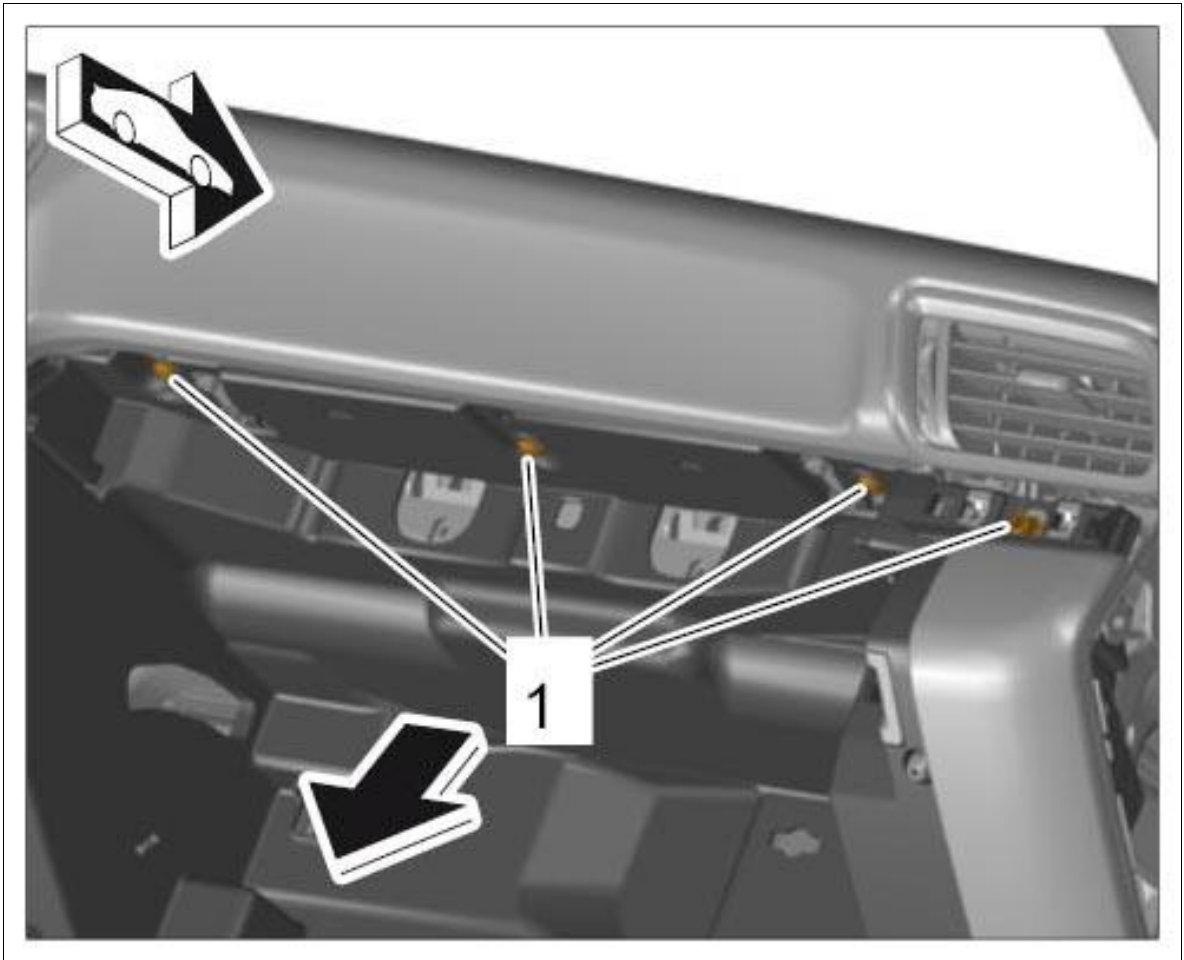

Courtesy of PORSCHE CARS NORTH AMERICA, INC.

4. Unclip the glove compartment **-arrow-** .

Fig 4: Unclipping Glove Compartment

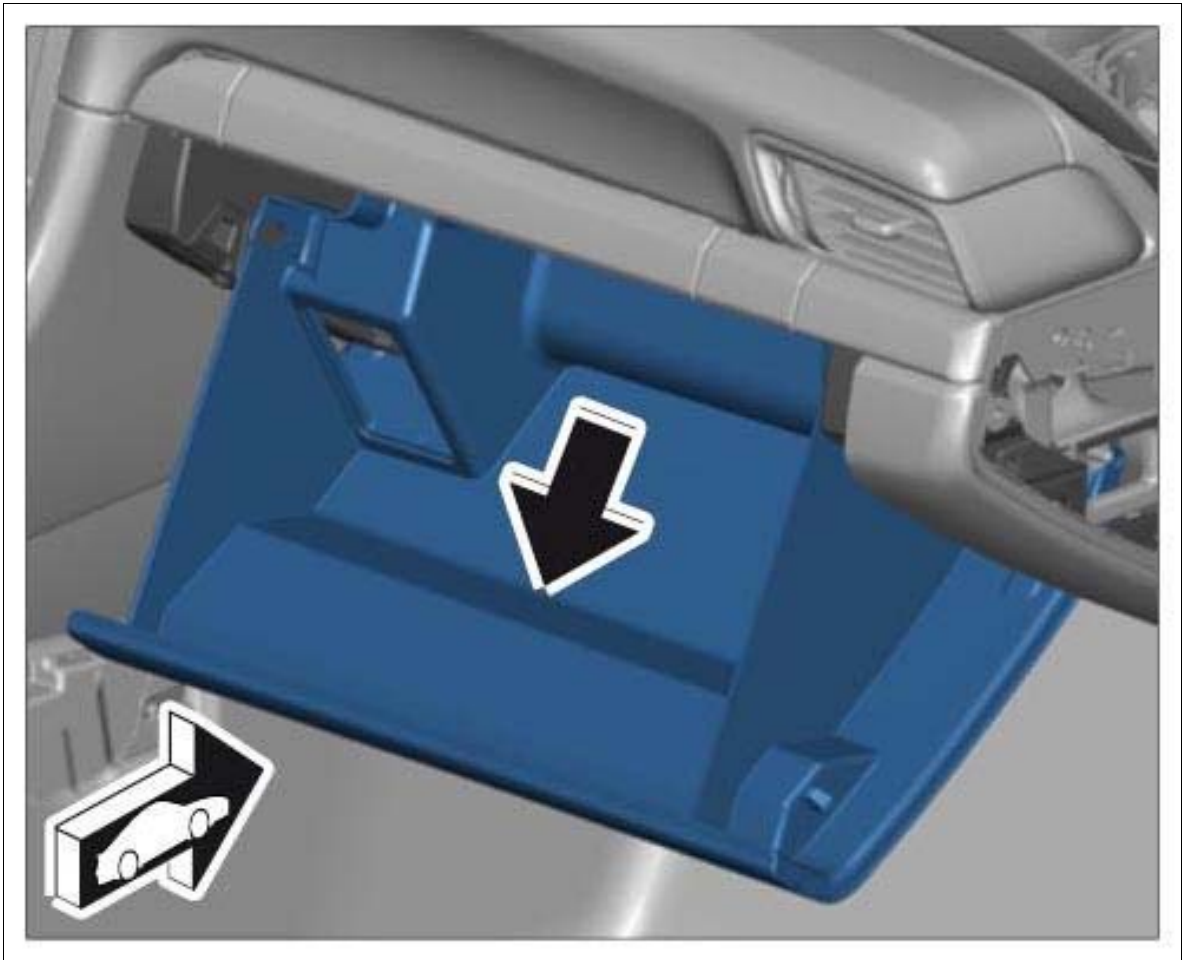

Courtesy of PORSCHE CARS NORTH AMERICA, INC.

5. Pull off plug connection for glove compartment light **-arrow-** .

Fig 5: Disconnecting Plug Connection

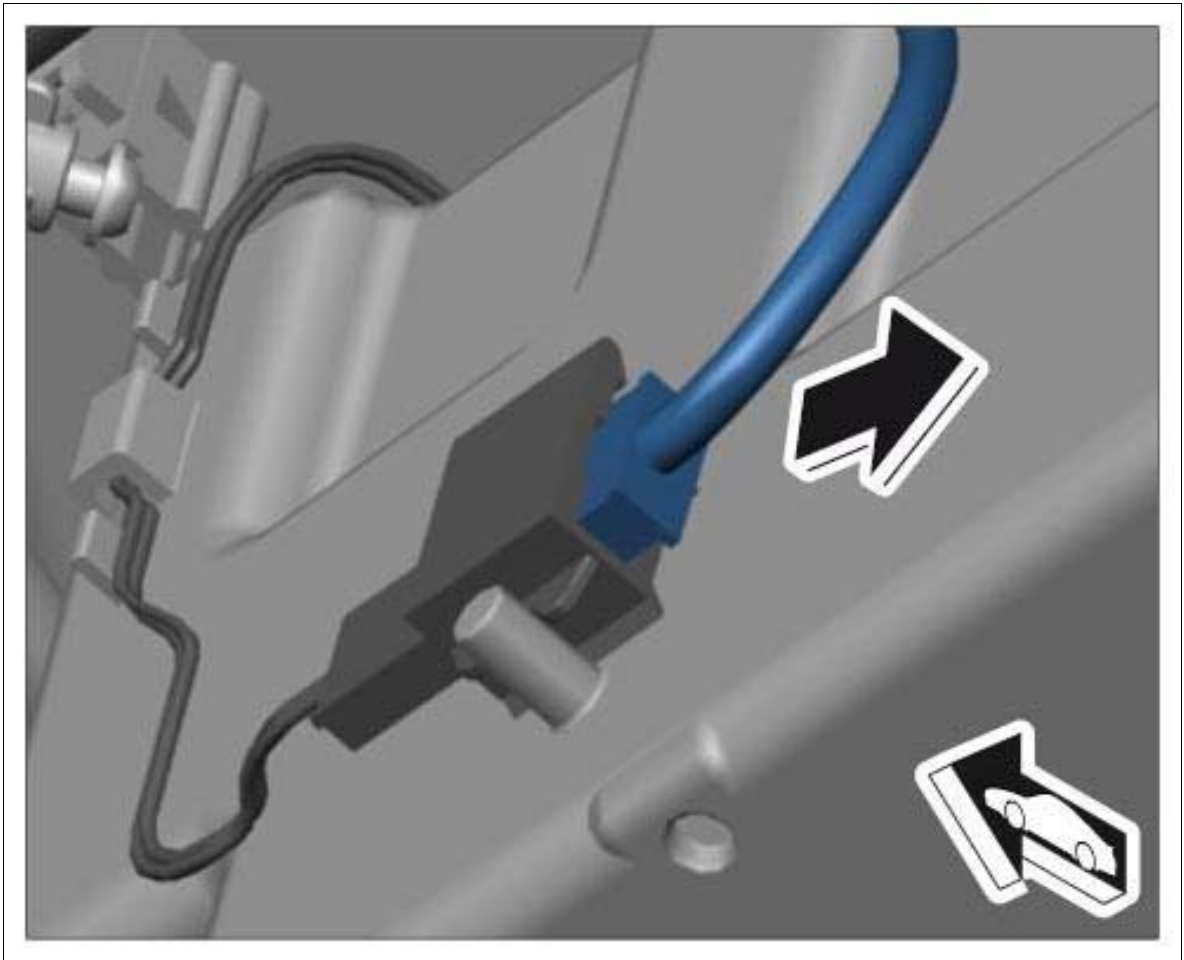

Courtesy of PORSCHE CARS NORTH AMERICA, INC.

6. Guide wire harness for multimedia interface out of the glove compartment **-arrow-** .

Fig 6: Guiding Out Wire Harness

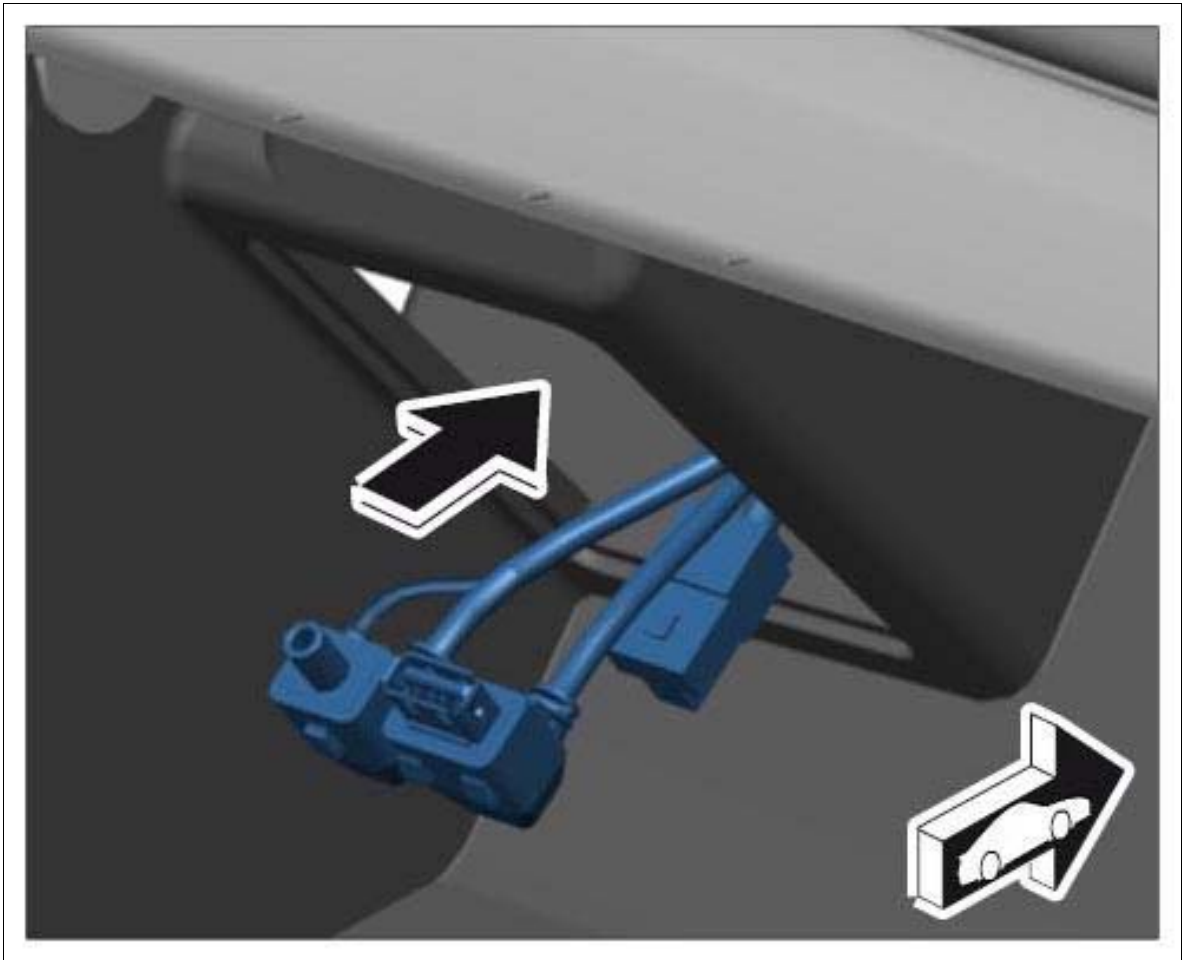

Courtesy of PORSCHE CARS NORTH AMERICA, INC.

## WM 681519 REMOVING AND INSTALLING GLOVE COMPARTMENT (ALL MODELS) > INSTALLING GLOVE COMPARTMENT

1. Plug in the plug connection for the glove compartment light **-arrow-** and check that it is seated securely.

Fig 7: Removing Rear-View Mirror

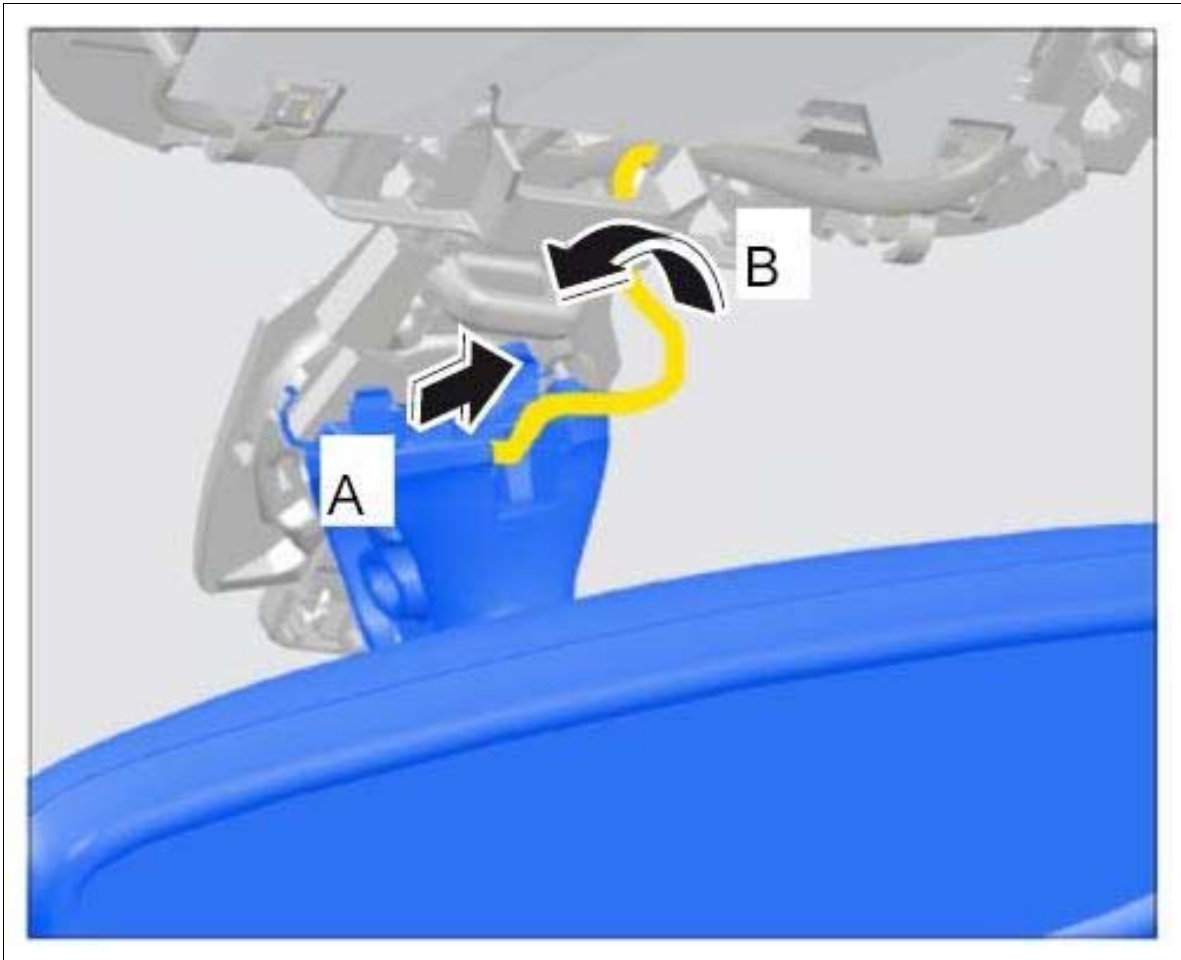

Courtesy of PORSCHE CARS NORTH AMERICA, INC.

### **WM 682719 REMOVING AND INSTALLING INTERIOR REAR-VIEW MIRROR (ALL MODELS) > INSTALLING INTERIOR REAR-VIEW MIRROR**

Installation is performed in reverse order to removal.

### **WM 682719 REMOVING AND INSTALLING INTERIOR REAR-VIEW MIRROR (ALL MODELS) > SUBSEQUENT WORK**

<sup>1)</sup> Only for vehicles with automatic anti-dazzle mirrors .

1. Install front roof trim panel → 708319 REMOVING AND INSTALLING FRONT ROOF TRIM PANEL - section on "Installing" <sup>1)</sup>

### **WM 683019 REMOVING AND INSTALLING CUPHOLDER (ALL MODELS) >**

## PRELIMINARY WORK

1. Remove dashboard molding on passenger's side → 705819 REMOVING AND INSTALLING DASHBOARD MOLDING on passenger's side - section on "Removing"

## WM 683019 REMOVING AND INSTALLING CUPHOLDER (ALL MODELS) > REMOVING CUPHOLDER

Fig 1: Identifying Cupholder Installation Position

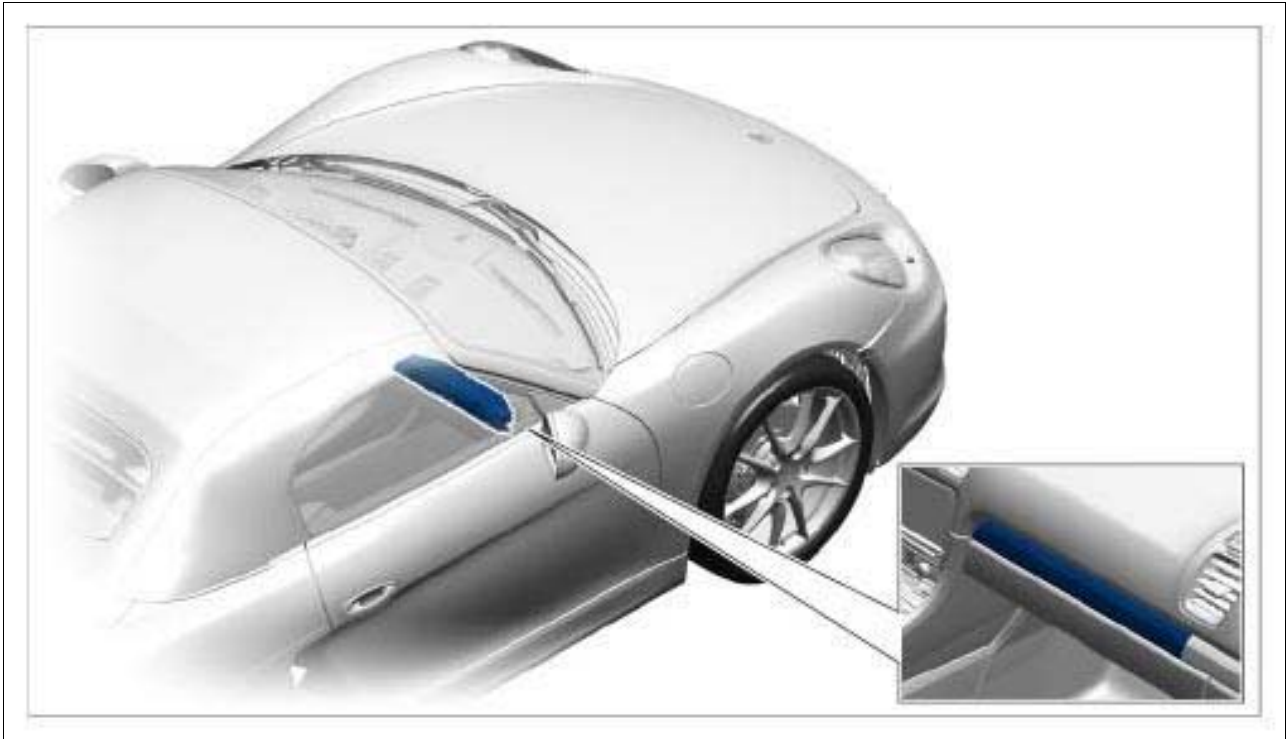

Courtesy of PORSCHE CARS NORTH AMERICA, INC.

1. Open the glove compartment -1- .
  - 1.1. Open the cupholder flap -2- .
  - 1.2. Pull out drinks slots -3- .

Fig 2: Opening Cupholder Flaps

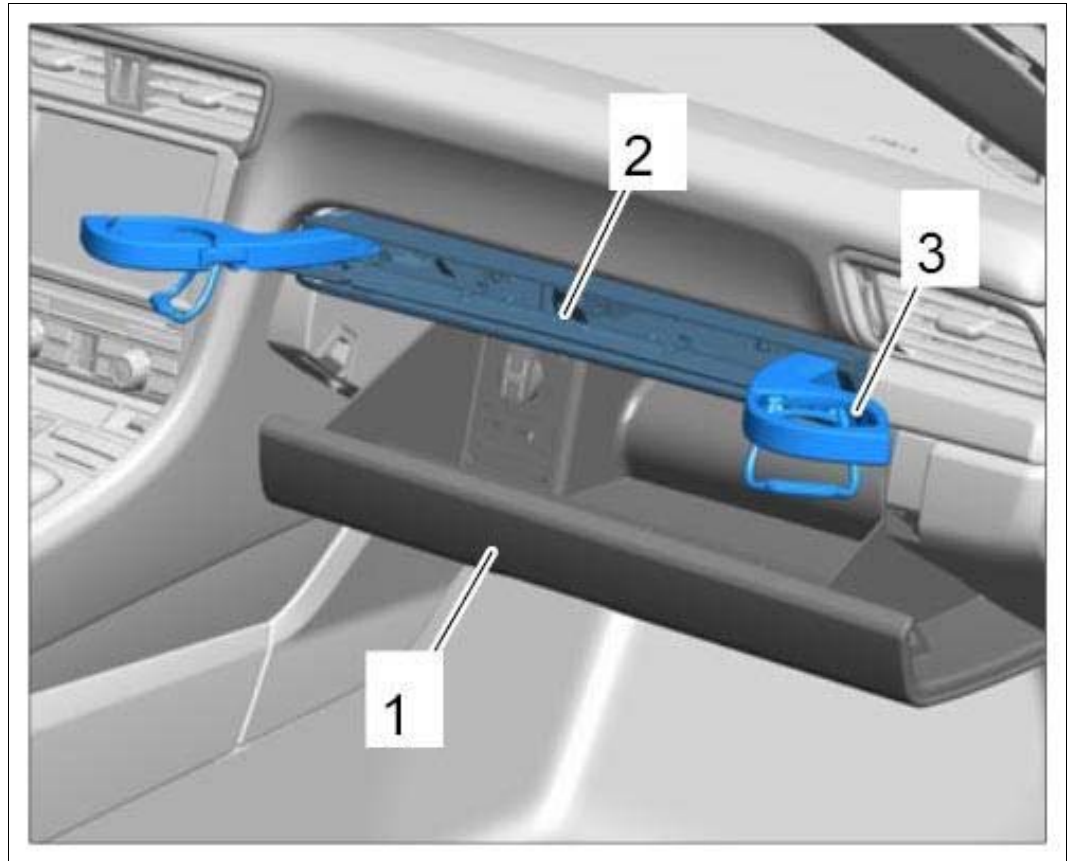

Courtesy of PORSCHE CARS NORTH AMERICA, INC.

2. Release cupholder.

1. 2.1. Release fastening clamp on the left and right **-arrow-** .

Fig 3: Releasing Cupholder

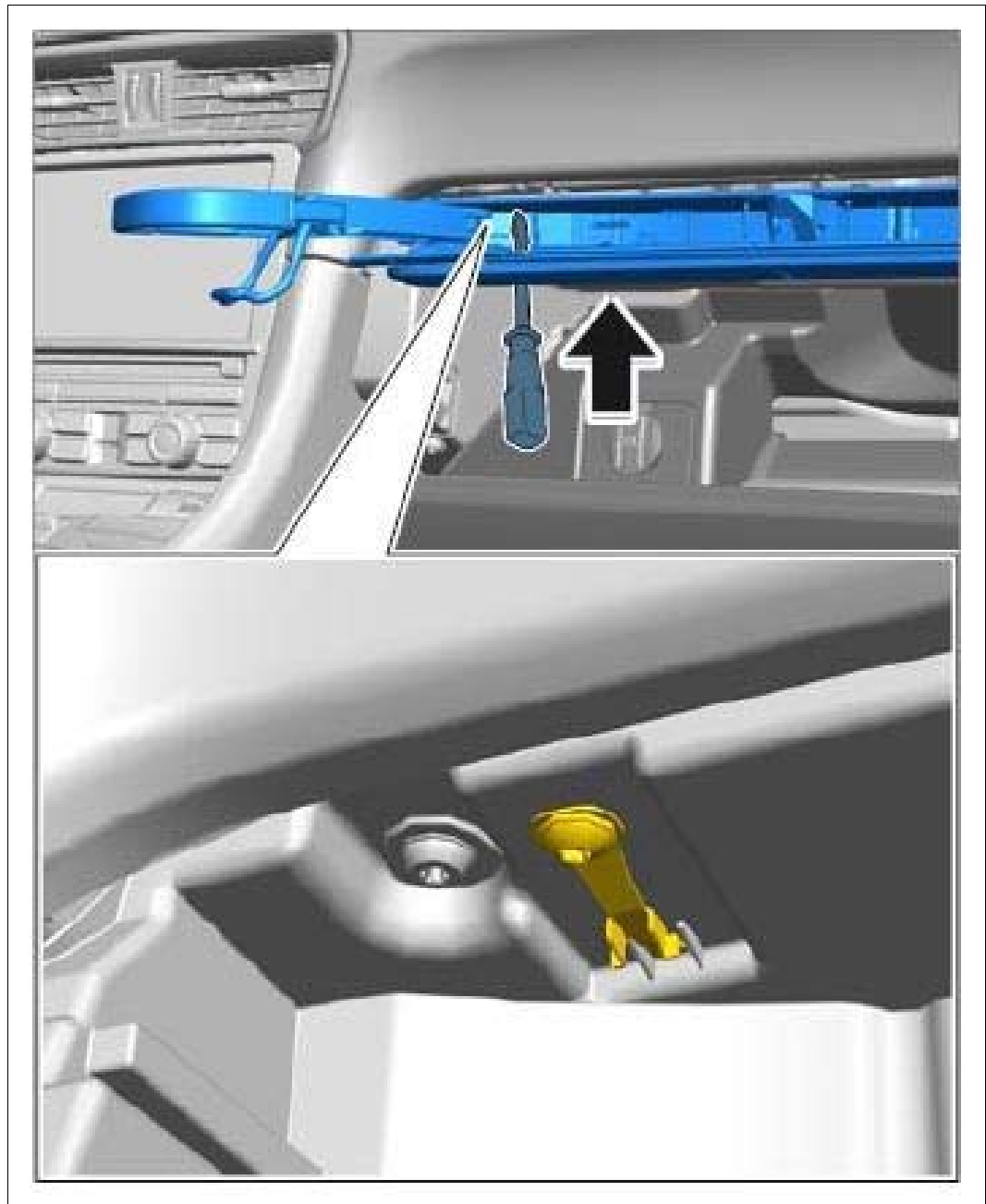

Courtesy of PORSCHE CARS NORTH AMERICA, INC.

3. Remove cupholder.

1. 3.1. Pull cupholder **-1-** out of the guide towards the passenger compartment **-arrow-**



Fig 4: Removing Cupholder

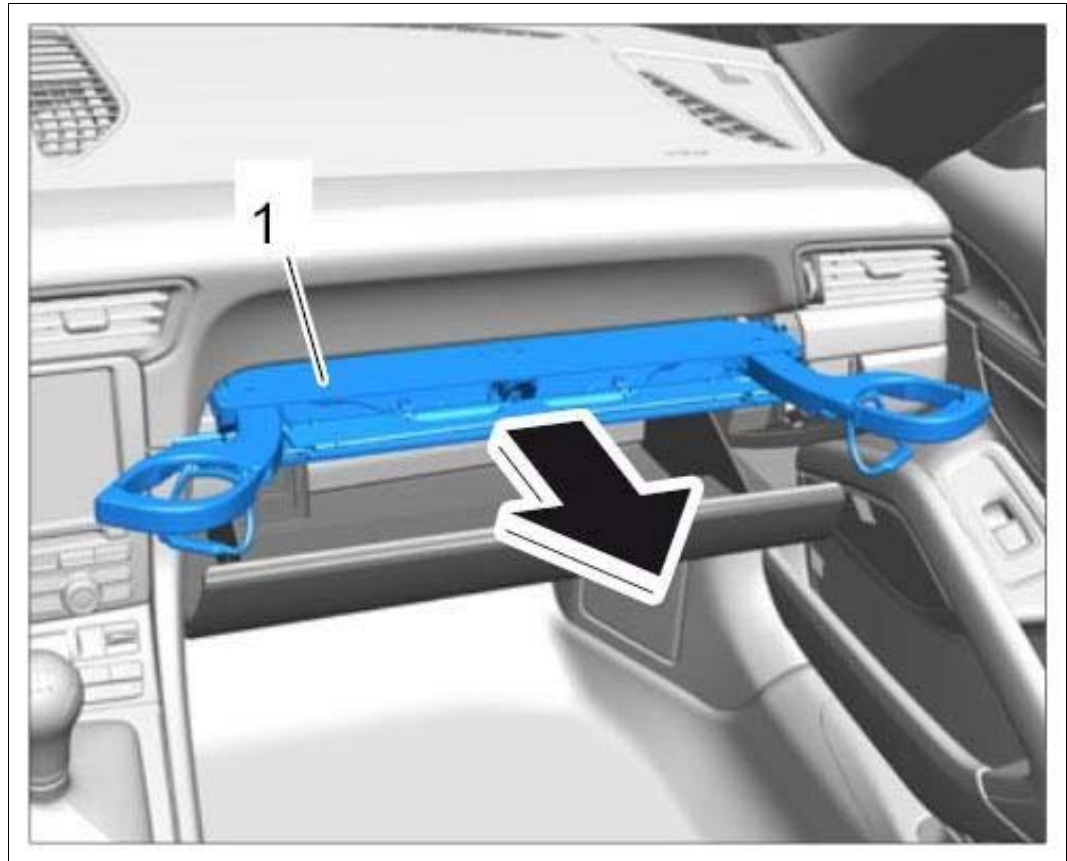

Courtesy of PORSCHE CARS NORTH AMERICA, INC.

### **WM 683019 REMOVING AND INSTALLING CUPHOLDER (ALL MODELS) > INSTALLING CUPHOLDER**

1. Installation is performed in reverse order to removal.

### **WM 683019 REMOVING AND INSTALLING CUPHOLDER (ALL MODELS) > SUBSEQUENT WORK**

1. Install dashboard molding on passenger's side → 705819 REMOVING AND INSTALLING DASHBOARD MOLDING on passenger's side - section on "Installing"

### **WM 684419 REMOVING AND INSTALLING TUNNEL SUPPORT (ALL MODELS) > TECHNICAL VALUES**

Location	Description	Type	Basic Value	Tolerance 1	Tolerance 2

1. Install trim panel for rear wall at the top. → Installing Trim Panel For Rear Wall
2. Install rear cover. → 705319 REMOVING AND INSTALLING REAR COVER
3. Install trim panels for package box. → 706619 REMOVING AND INSTALLING PACKAGE BOX

## **WM 701619 REMOVING AND INSTALLING DASHBOARD TRIM PANEL (ALL MODELS) > REMOVING DASHBOARD TRIM PANEL**

### **Information**

Some of the repair illustrations show only one side of the vehicle. Naturally, some steps also have to be performed on the opposite side of the vehicle as well. These must be carried out as a mirror image of the steps shown.

Fig 1: Identifying Dashboard Trim Panel Installation Position

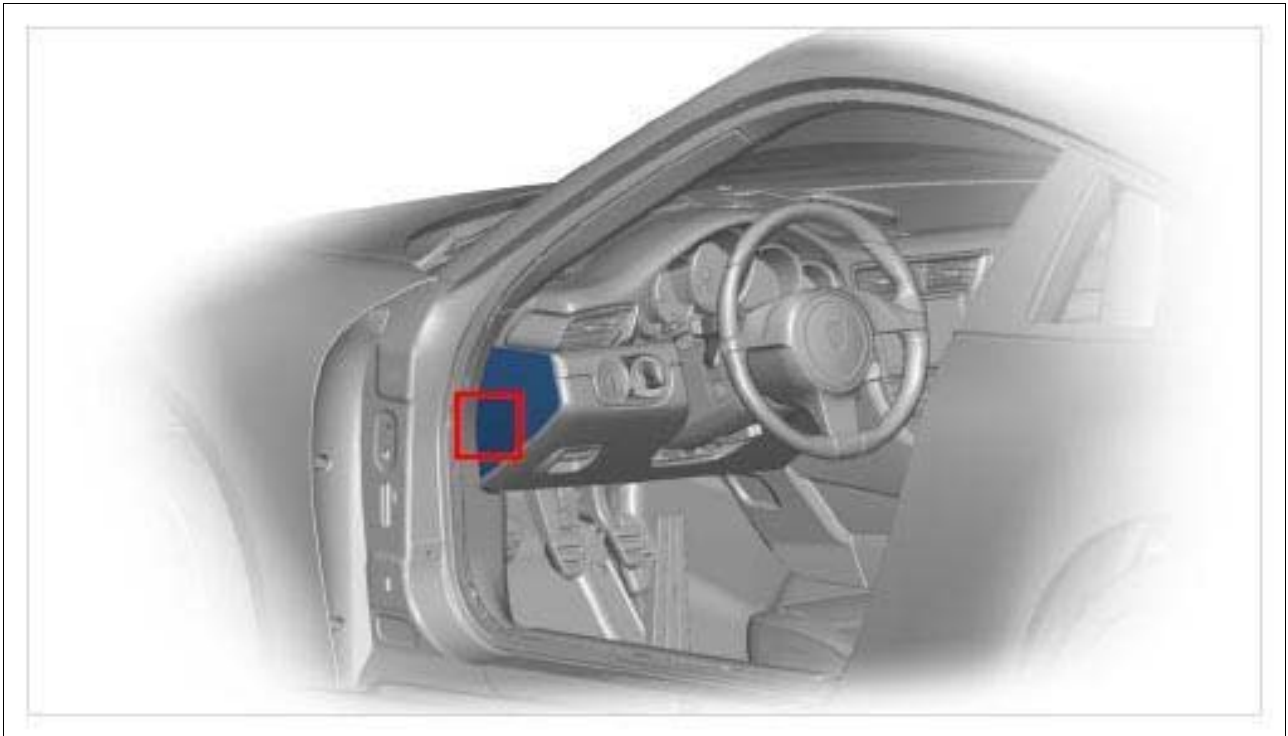

Courtesy of PORSCHE CARS NORTH AMERICA, INC.

1. Unclip dashboard trim panel and remove it by pulling it to the rear **-arrow-** .

Fig 2: Removing Dashboard Trim Panel

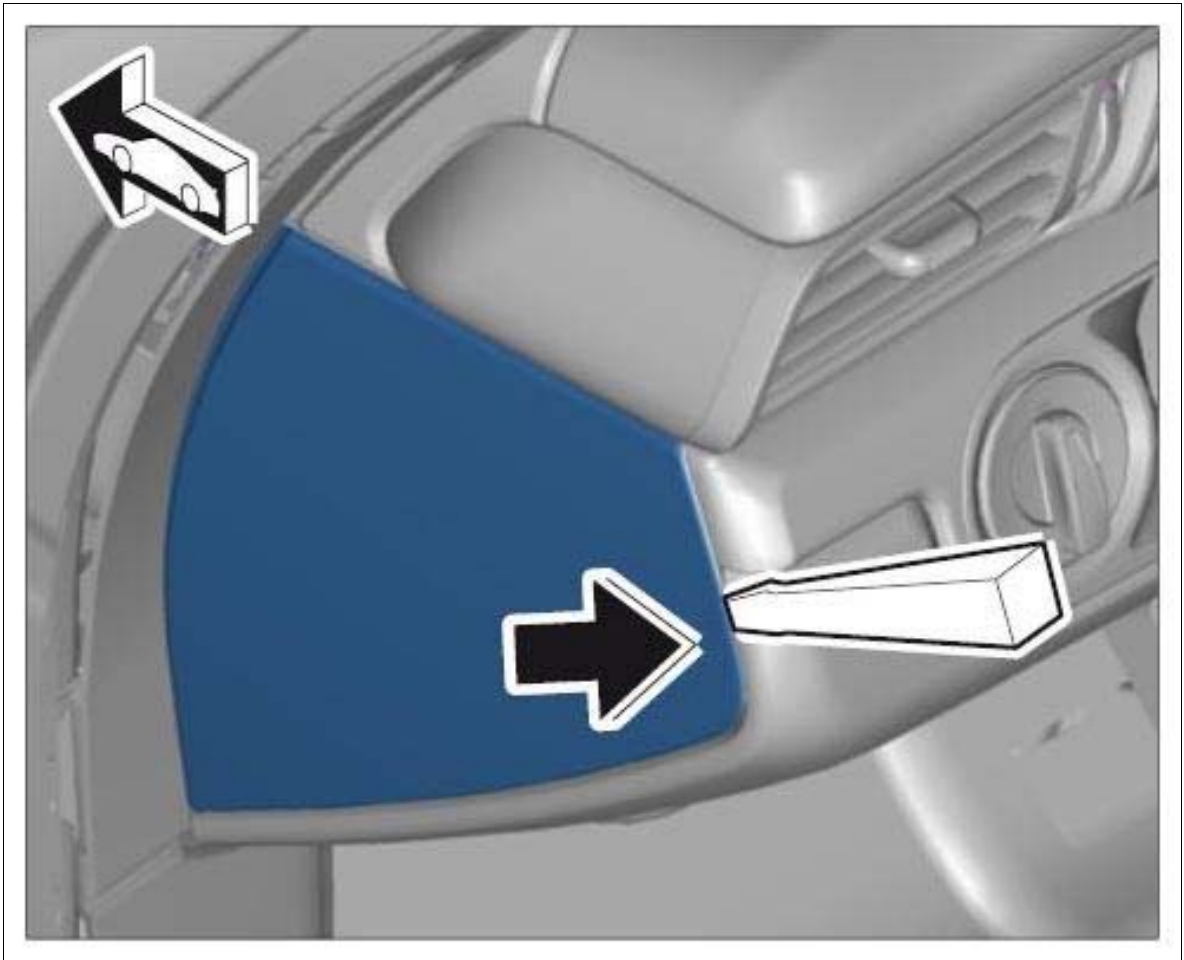

Courtesy of PORSCHE CARS NORTH AMERICA, INC.

**WM 701619 REMOVING AND INSTALLING DASHBOARD TRIM PANEL (ALL MODELS)  
> INSTALLING DASHBOARD TRIM PANEL > INSTALLING DASHBOARD COVER**

1. Fit dashboard trim panel in installation position and clip it in **-arrow-** .

Fig 1: Removing Dashboard Molding On Driver Side (Right)



Courtesy of PORSCHE CARS NORTH AMERICA, INC.

**WM 705819 REMOVING AND INSTALLING MOLDING FOR DASHBOARD (ALL MODELS) > REMOVING MOLDING FOR DASHBOARD > REMOVING DASHBOARD MOLDING ON PASSENGER'S SIDE**

**Information**

To reduce the unclipping forces and thereby the risk of damage during removal, the removal steps must be carried out at the accessible connection points using a suitable tool.

1. Carefully unclip dashboard molding on passenger's side **-arrow-** .

Fig 1: Removing Dashboard Molding On Passenger Side

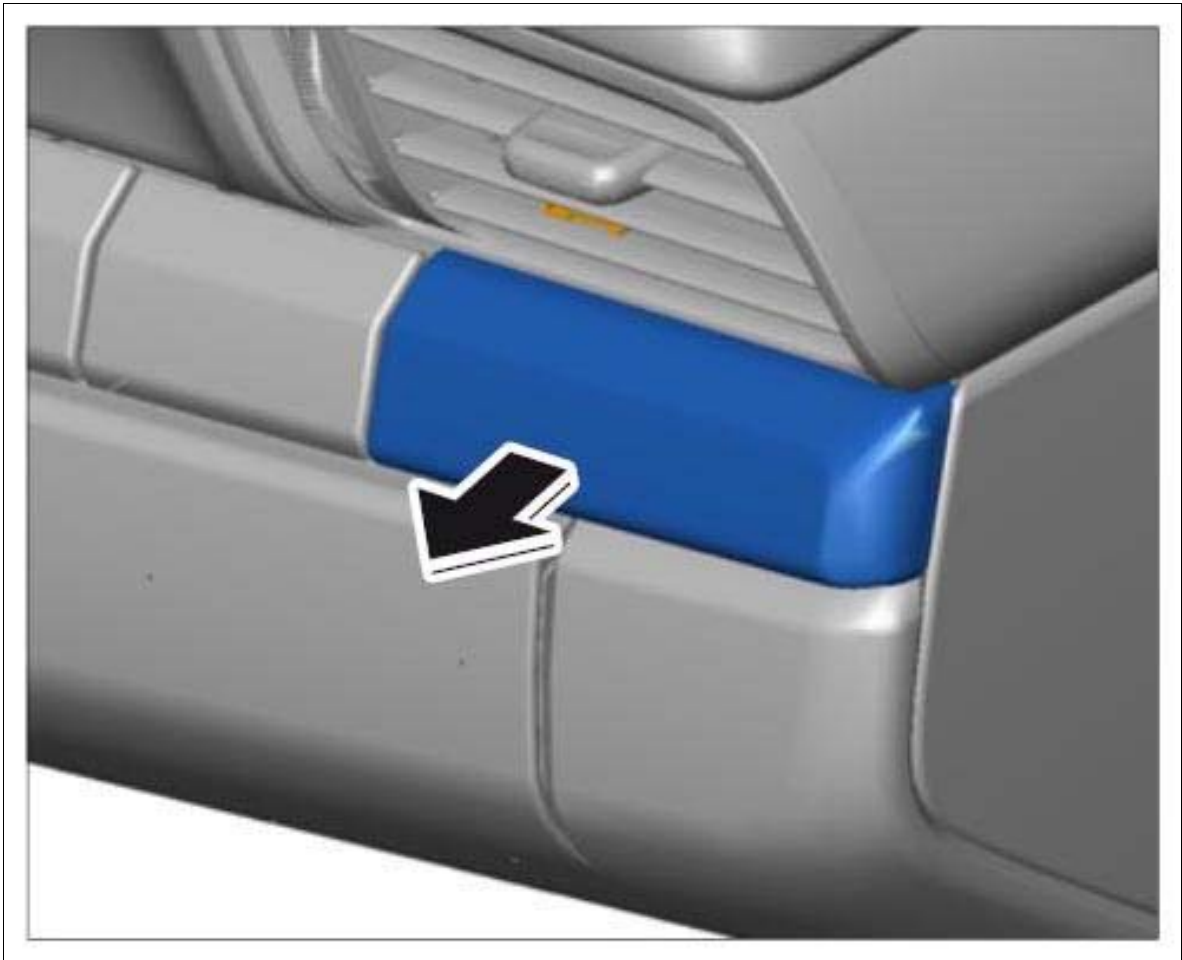

Courtesy of PORSCHE CARS NORTH AMERICA, INC.

**WM 705819 REMOVING AND INSTALLING MOLDING FOR DASHBOARD (ALL MODELS) > INSTALLING MOLDING FOR DASHBOARD > INSTALLING DASHBOARD MOLDING**

1. The dashboard molding on the driver's side and the molding on the passenger's side are installed in reverse order to removal.

**WM 705919 REMOVING AND INSTALLING DOOR PANEL (EXCEPT CAYMAN GTS, CAYMAN GT4) > TECHNICAL VALUES**

Location	Description	Type	Basic value	Tolerance 1	Tolerance 2
Fastening screw for door panel		Tightening torque	7.5 Nm (5.5 ftlb.)	+/-0.5 Nm (+/-0.5 ftlb.)	