

| | | | | | | | | | | | |
|-------|------|-----|----|--------------|--------------|-----|--------------|------------|----------|-----|----------|
| Model | Year | M/G | SG | Illustration | Restrictions | UPD | 9:57 | 31.01.2010 | PORSCHES | PET | PORSCHES |
| 928 | 1991 | 1 | 03 | 103-10 | | 248 | USA / CANADA | | | | |

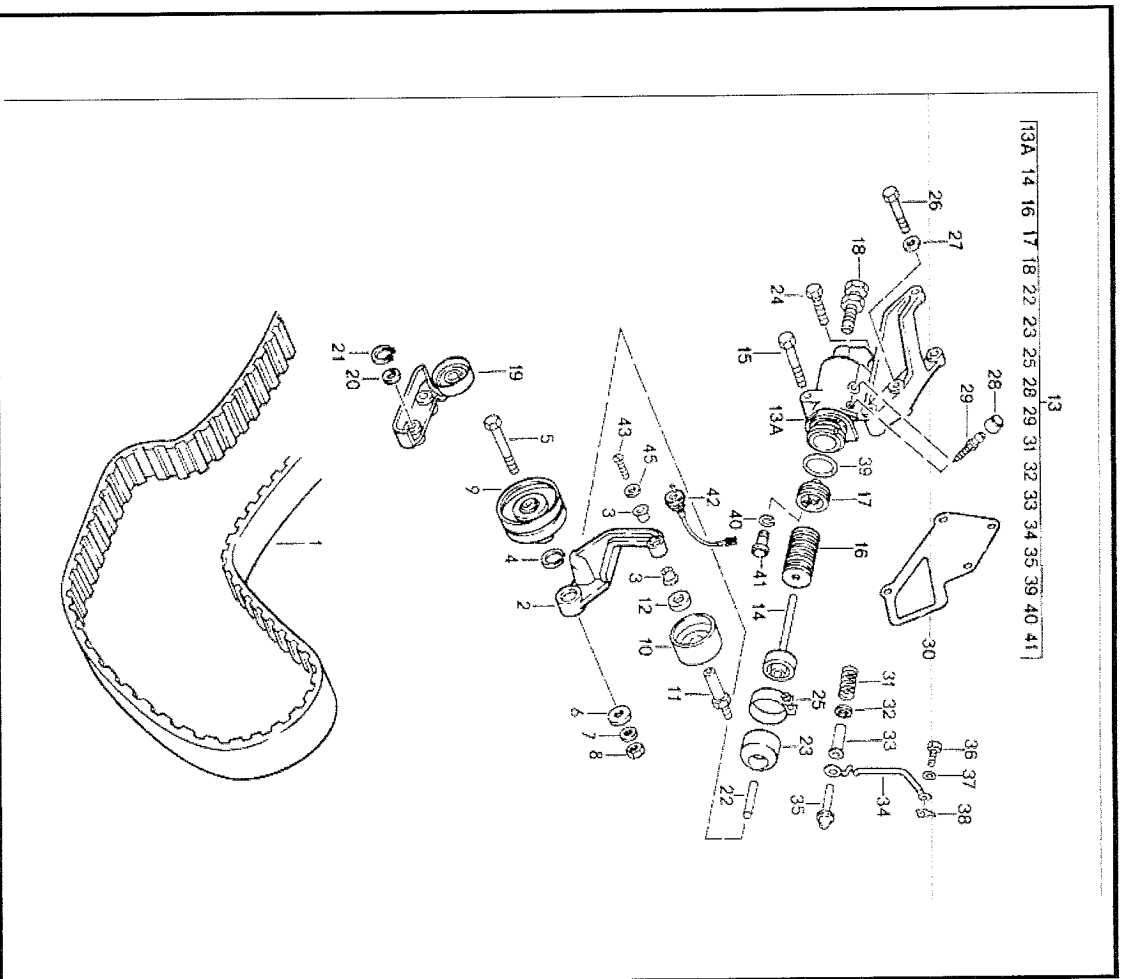

| Pos | Part Number | Description | Remark | Qty | Model |
|-----|----------------|----------------------------|--------|-----|--------------|
| 1 | 928 105 157 30 | driving mechanism camshaft | | 1 | M28.41/42/47 |
| 1 | 928 105 157 50 | toothed belt | 87 | 1 | |
| 1 | 928 105 157 50 | toothed belt | 88-90 | 1 | |
| 1 | 928 105 157 50 | toothed belt | 91- | 1 | |
| 2 | 928 105 489 02 | carrier for tension roller | | 1 | |
| 3 | 928 105 613 04 | bearing sleeve | | 2 | |
| 4 | K 042 364 1 | circledip 20 X 1,75 | | 1 | |
| 5 | 900 074 139 02 | hexagon-head bolt M 8 X 55 | | 1 | |
| 6 | 909 025 068 07 | washer 9 X 25 X 3,5 | | 1 | |
| 7 | 900 025 007 02 | washer A 9,4 | | 1 | |
| 8 | 909 076 025 02 | hexagon nut M 8 | | 1 | |
| 9 | 928 105 512 12 | tensioning roller | | 1 | |
| 10 | 928 105 571 04 | roller | | 1 | |
| 11 | 928 105 570 08 | beating pin | | 1 | |
| 12 | 928 105 572 00 | washer | | 1 | |
| 13 | 928 105 036 00 | tension roller housing | | 1 | |
| 13A | 928 105 066 00 | tension roller housing | | 1 | |
| 14 | 928 105 059 04 | piston | | 1 | |
| 14 | 928 105 059 04 | piston | | 1 | |
| 15 | N 010 360 6 | hexagon-head bolt M 8 X 60 | | 1 | |
| 16 | 928 105 539 03 | 51-metal plate | | 35 | |
| 17 | 928 105 588 00 | valve support | | 1 | |
| 18 | 928 105 075 03 | adjusting screw | | 1 | |
| 19 | 928 105 067 00 | carrier for tension roller | | 1 | |

M28.41
M28.42
M28.43
M28.44
M28.45
M28.46
M28.47
M28.48
M28.49
M28.50
M28.51
M28.52
M28.53
M28.54
M28.55
M28.56
M28.57
M28.58
M28.59
M28.60
M28.61
M28.62
M28.63
M28.64
M28.65
M28.66
M28.67
M28.68
M28.69
M28.70
M28.71
M28.72
M28.73
M28.74
M28.75
M28.76
M28.77
M28.78
M28.79
M28.80
M28.81
M28.82
M28.83
M28.84
M28.85
M28.86
M28.87
M28.88
M28.89
M28.90
M28.91
M28.92
M28.93
M28.94
M28.95
M28.96
M28.97
M28.98
M28.99
M28.100